

Decora Smart® Z-Wave® 800 Series 15A Switch



The Decora Smart Z-Wave 800 Series Switch is designed for use with modern Z-Wave hubs and makes it easier than ever to add smart lighting control to your home.

The ZW15S is compatible with any Z-Wave enabled network, regardless of the manufacturer, and can also be used with other devices displaying the Z-Wave logo. The ZW15S acts as a repeater to help increase the reliability of the Z-Wave network.

The Decora Smart Z-Wave 800 Series Switch aesthetically matches Decora® in-wall devices and features intuitive on/off control. Add the switch to a certified Z-Wave hub to enable app commands, scheduling, and voice control of connected lighting.

BENEFITS

- **Never come home to a dark house again** – schedule exterior lights to turn on at sunset
- **Know if lights are on and adjust them whether you're home, at work, or on vacation** – control from anywhere using a compatible Z-Wave hub
- **Use your voice for control without lifting a finger** – using a compatible Z-Wave hub
- **Control this switch from another wall location in your home** – pairs with DDOSR Wired Switch Companion
- **Increase the reliability of your Z-Wave network** – acts as a repeater to strengthen your Z-Wave Mesh network

FEATURES

- **One switch does it all** – supports on/off switching of loads up to 15A and 3/4 HP for control of lights, ceiling fans, exhaust fans, motors, pumps, and more
- **Remote access, voice command, and scheduling** – as part of a Z-Wave smart home solution
- **Easy Install** – replaces your existing switch; wire leads and slim design make install a breeze
- **Single Pole or 3-Way** – works with DDOSR Wired Switch Companion
- **Change the color** – using DDKIT faceplates available in six colors (see ordering information)

Z-WAVE PLUS V2 CERTIFIED (800 SERIES)

- Supports Z-Wave 8th generation mesh wireless for control of connected lighting with certified Z-Wave hubs
- Compatible with any Z-Wave enabled network; works with other devices displaying the Z-Wave logo; backwards compatible with all generations of Z-Wave devices
- Meets the Z-Wave specification for the latest in speed, performance, and security
- Supports SmartStart enrollment when used with a Z-Wave controller that supports SmartStart inclusion. Also supports Network wide inclusion, and Classic inclusion enrollment methods
- Supports S2 Security and Z-Wave Over-the-Air updates
- Reference the Getting Started Guide for installation instructions and Advanced Options that can be configured over the Z-Wave network as well as a list of supported Z-Wave associations and classes

TECH SPECS

- Neutral wire required for installation
- Z-Wave Plus Network – 908.40, 908.42, 916.00 MHz
- Z-Wave Range: 50 feet to the hub or another Z-Wave enabled repeater

WIRED 3-WAY/MULTI-LOCATION CONTROL

The Decora Smart Z-Wave Plus Switch can be paired with a DDOSR Switch Companion to control the lights from more than one location.

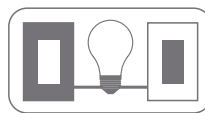

RATINGS

- General Use – 15A, 120VAC, 60Hz
- LED/CFL/Electronic Ballast – 5A
- Incandescent/Halogen – 1500W
- Magnetic Ballast – 15A
- Motor – 3/4 HP
- Operating Temperature – 0° to 40° C (32° – 104° F)
- Operating Humidity – 10% to 90% non-condensing

AGENCY STANDARDS AND COMPLIANCE

- Complies with UL917; CSA C22.2 No. 177-13
- CSA Certified for USA and Canada
- NOM Certified
- Z-Wave Plus v2 Certified
- Complies with FCC Part 15, Class B
- FCC ID: QGH-ZW15S
- IC: 2473A-ZW15S

WARRANTY INFORMATION

- Two-Year Limited Warranty

DIMENSIONAL DRAWINGS

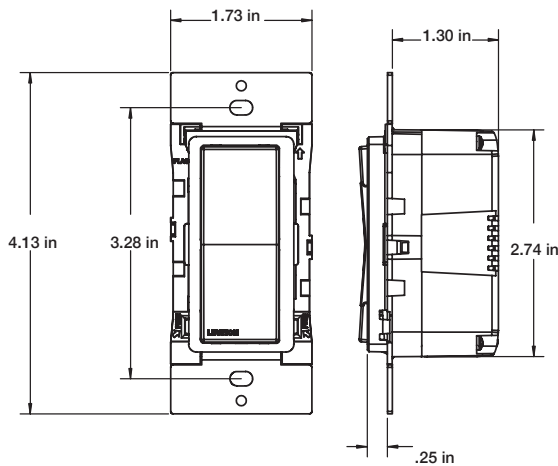

SINGLE POLE WIRING DIAGRAM

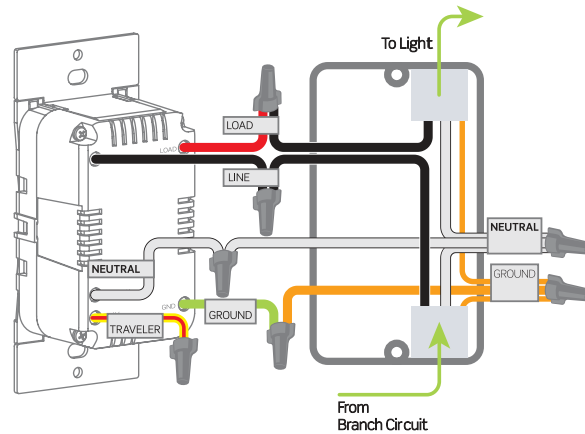

SMARTSTART ENROLLMENT

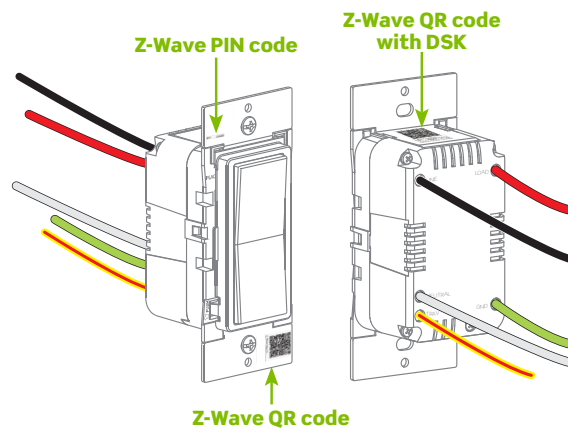

DESCRIPTION	CAT. NO.
Decora Smart Z-Wave 800 Series Switch	ZW15S
COMPANION DEVICE FOR MULTI-LOCATION APPLICATIONS	
Decora Smart Switch Companion with LED Locator (Wired)	DD0SR-DLZ
Decora Smart Switch Companion no LED Locator (Wired)	DD0SR-1
ACCESSORIES	
Decora Smart Switch Faceplate - White	DDKIT-OSW
Decora Smart Switch Faceplate - Ivory	DDKIT-OSI
Decora Smart Switch Faceplate - Light Almond	DDKIT-OST
Decora Smart Switch Faceplate - Gray	DDKIT-OSG
Decora Smart Switch Faceplate - Black	DDKIT-OSE
Decora Smart Switch Faceplate - Brown	DDKIT-OSB

Leviton Manufacturing Co., Inc. Global Headquarters

201 N. Service Rd. Melville, NY 11747-3138 Tech Line: 1-800-824-3005 Fax: 1-800-832-9538

scan to learn more

