

Single Pole Wide View Motion Activated Light Control



Cat. Nos. DOS02, DVS02 - INDOOR USE ONLY

Ratings: 120VAC, 60Hz 250 W Incandescent/Halogen, 2 A Resistive, 150W LED and CFL, 250 VA ELV, 200VA MLV

WARNINGS:

- **TO AVOID FIRE, SHOCK OR DEATH: TURN OFF POWER AT CIRCUIT BREAKER OR FUSE AND TEST THAT THE POWER IS OFF BEFORE WIRING!**
- **TO AVOID PERSONAL INJURY OR PROPERTY DAMAGE, DO NOT** install to control a receptacle, or a load in excess of the specified rating.
- To be installed and/or used in accordance with electrical codes and regulations.
- If you are not sure about any part of these instructions, consult an electrician.

CAUTIONS:

- To avoid damage to the product, **DO NOT** use disinfecting products, including foggers, sprays or other types of atomized cleaning agents.
- **DO NOT** spray liquid onto the product.
- To clean use a damp cloth with mild soap.
- No user serviceable components. **DO NOT** attempt to service or repair.
- Use this device **WITH COPPER OR COPPER CLAD WIRE ONLY.**

PK-A3345-10-00-2B

INSTALLATION INSTRUCTIONS

ENGLISH

Features

- Cat. Nos. DOS02 and DVS02 have a sensing angle of 180° and a sensing area of coverage of 30 x 30 ft. See coverage diagram for details.
- Adjustable ambient light (DOS02 only), time delay and area of coverage controls. See adjustment setting section for details.
- Indicator light alerts the user of device status.
- Adjustable time delay setting for 1, 5, 10 and 20 minutes plus a test mode with 5 seconds on. A Temporary Bypass mode that disables the Auto-on feature is available only for DOS02.
- With Zero Cross turn-ON technology to extend the life of the switching relays.
- Color change kits are available in white, light almond, ivory, black, brown, and gray.
- Also available with larger loads, 3-way (cat. nos. DOS05/DVS05) and multi-way or multi-sensor (cat. nos. DOS15/DVS15)

Mounting Location

- The device responds to temperature changes and care should be taken when mounting the device.
- **DO NOT** mount directly above a heat source, in a location where hot or cold drafts will blow directly on the sensor, or where unintended motion (e.g., hallway traffic) will be within sensor's field-of-view.

You Will Need

- Slotted/Phillips screwdriver
- Electrical tape
- Cutters
- Pliers

Installation

WARNING: TO AVOID FIRE, SHOCK OR DEATH, turn off power at circuit breaker or fuse and test that the power is off before wiring.

1. Identify your wires (most common):

NOTE: Neutral wire (if present), or a Ground wire is required for operation.
If the wiring in the wall box does not resemble this configuration, consult an electrician.

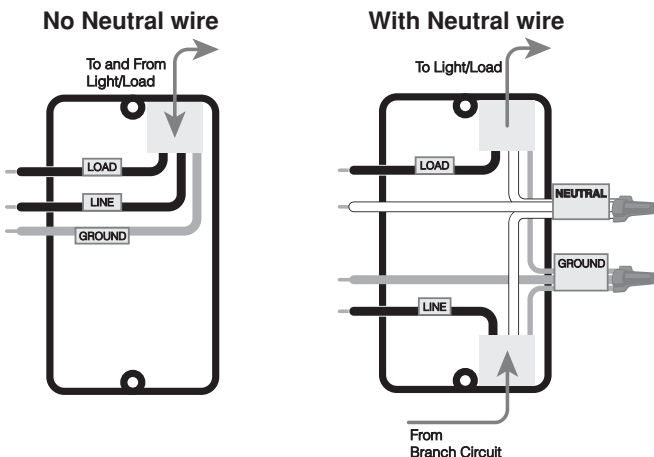

2a. Wire (when Neutral is NOT present).

Working on one connection at a time, connect wires as shown.

NOTES:

- This device is designed so the Line and Load wires can be wired interchangeably.
- Both GREEN wires need to be connected to Ground.

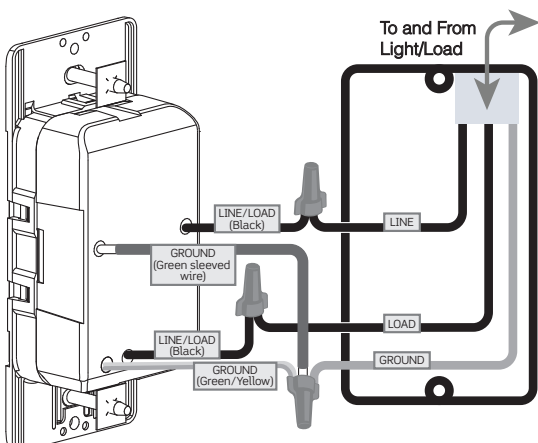

2b. Wire (when Neutral is present).

Remove the Green sleeve from the White wire. Working on one connection at a time, connect wires as shown.

NOTE: This device is designed so the line and load wires can be wired interchangeably.

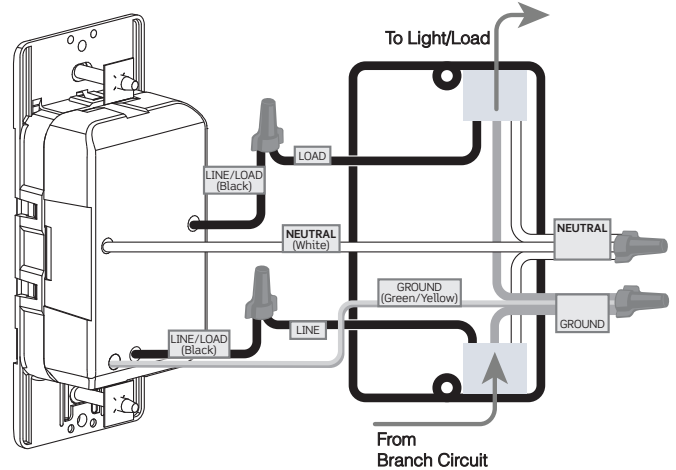

3. Test and mount.

- Restore power. Wait 10-20 seconds for sensor to power up.
- Lights will turn ON when push pad is pressed. For cat. no. DOS02, the lights will also turn ON with any motion event after the warm-up period.

NOTE: If lights do not turn ON, refer to the "What to do if..." section.

Turn off power at circuit breaker before completing the installation.

- Gently push wires into wall box. Screw light control to box.
- Install wallplate.
- Restore power.

Operation

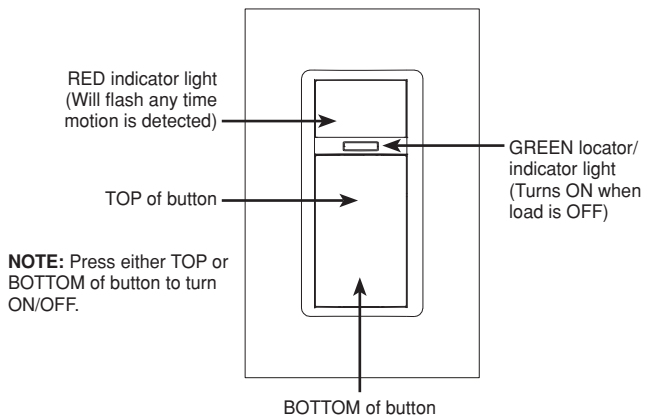

NOTE: Press either TOP or BOTTOM of button to turn ON/OFF.

Changing your device color

Remove

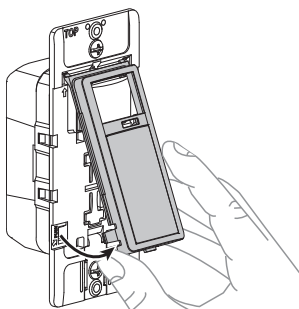

Replace

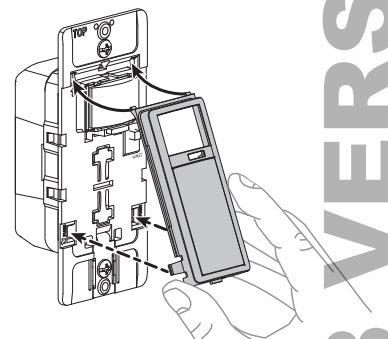

Available in White (W), Light Almond (T), Ivory (I), Brown (B), Black (E), Grey (G), (DOSKT-1Lx)

WEB VERSION

Programming

1. Enter Programming Mode. Make sure the load is ON.

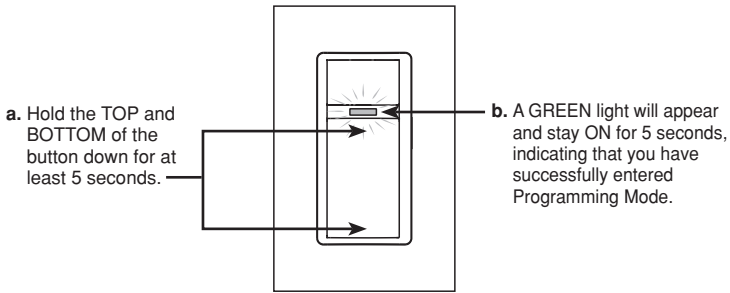

2. Select each setting you wish to change, one at a time, to program the option desired (see table below).

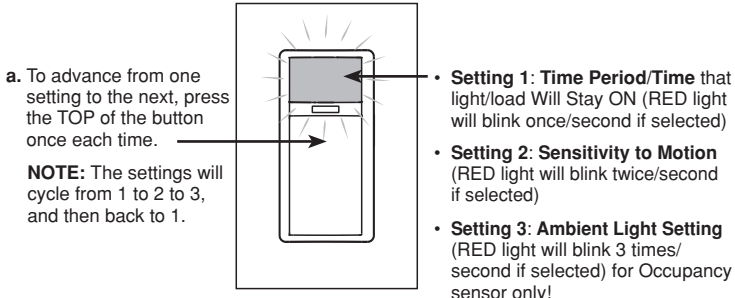

NOTE: Once you enter Programming Mode, multiple settings can be changed before saving and exiting.

3. Change the option within each setting (see the table below for the options).
NOTE: The default option for each setting is listed in the table in bold.

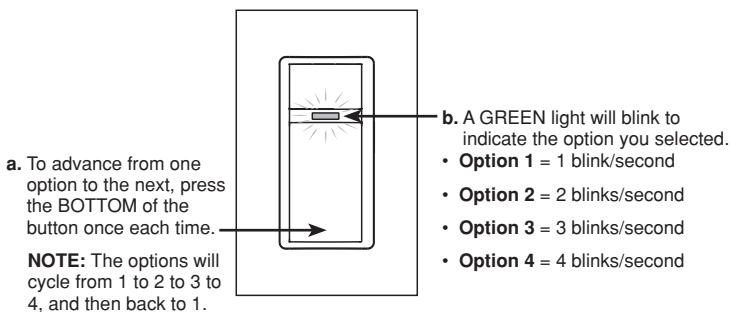

4. Save your settings and exit the Programming Mode.

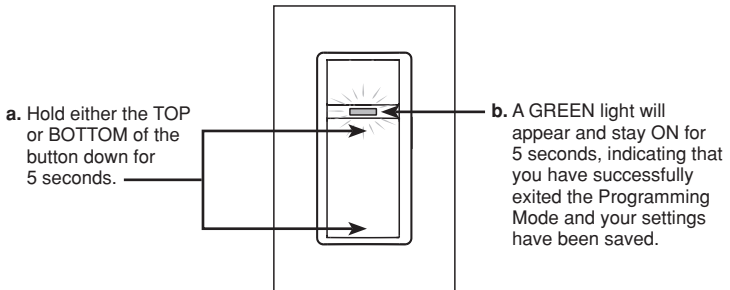

NOTES:

- After 30 seconds of inactivity, the device will automatically exit Programming Mode and setting changes will not be saved.
- When you enter Programming Mode again, you will start at the Timer setting, in the last saved option row (default is Option 3: 10 minutes).

Setting Types and Options (defaults are in bold)			
	Setting 1	Setting 2	Setting 3
Option Number	TIMER (Duration of time for which load is ON since last detected motion)	SENSITIVITY (Sensitivity to motion – adjusting the major and minor detection range.)	DOS02 only - AMBIENT LIGHT (If the room is brighter than the setting selected, the load will not turn ON.)
Option 1 (1 blink)	1 minute	Low (50% Range)	Low Light level
Option 2 (2 blinks)	5 minutes	Medium	Medium Light level
Option 3 (3 blinks)	10 minutes	High	High/Brightest light level
Option 4 (4 blinks)	20 minutes	All settings to default	Disabled – turns ON for all light levels

Test Mode

1. To test that your device is working properly, hold the TOP of the button down for 5 seconds. A RED light will blink once every 2 seconds.
 2. Walk around in any area to be tested. During Test Mode, every motion detected will trigger the load for 5 seconds.
 3. Exit Test Mode by pressing either the TOP or BOTTOM of the button. The Test Mode will also time-out after 2 minutes.
- The locator LED function is disabled while in Test Mode.

Temporary Disable

1. To temporary disable the light or load from turning on, press and hold the bottom of the button for 5 seconds.
2. The sensor will ignore motion keeping the light/load off. GREEN light will double flash every 2 seconds during this mode.
3. Exit by pressing either the top or bottom of the button.

When to use Occupancy or Vacancy				
Programing Mode	When to use this setting	Amount of Ambient Light Present	Turns light ON when...	Light turns OFF when...
Occupancy (DOS02 only)	When automatic ON/OFF lighting control is desired.	1. Low - Light will turn ON automatically if room is darkest. 2. Medium- Light will turn ON automatically if room has more light. 3. High - Light will turn ON automatically if room has the most light 4. Disabled - Light will turn ON always.	User walks into the view of the sensor when the light is OFF and it is darker than the ambient light level set. OR TOP or BOTTOM of button is pushed.	No motion is detected for the duration of the programmed time period. OR TOP or BOTTOM of button is pushed.
Vacancy	When Manual ON, Automatic OFF lighting control is desired.	N/A	TOP or BOTTOM of button is pushed. OR User moves around within 30 secs of the light turning OFF.	TOP or BOTTOM of button is pushed. OR No motion is detected for the duration of the programmed time period.

NOTE: When pressing the button to turn the light OFF manually, the sensor will ignore motion for 30 seconds to allow user to exit the room (without re-triggering the light).

Occupancy/Vacancy Switch (DOS02 only)

Remove color kit and wallplate to access.

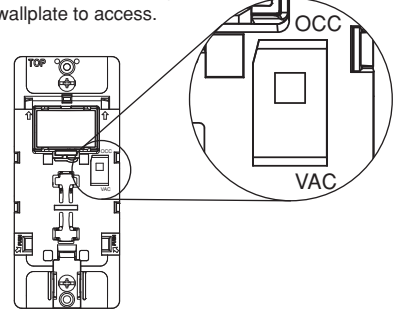

Sensing Area Coverage

1. Horizontal field of view:

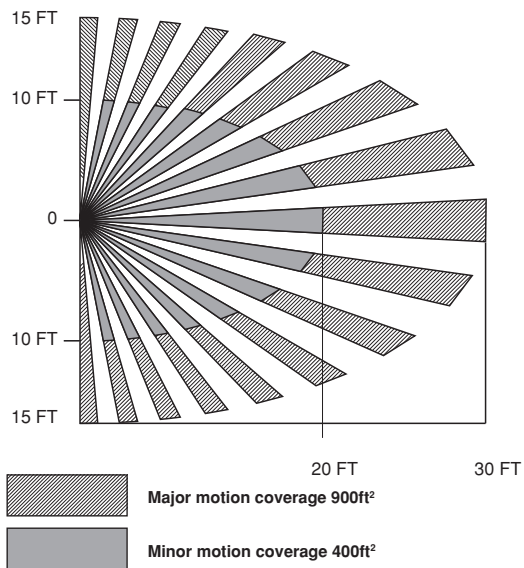

2. Vertical field of view:

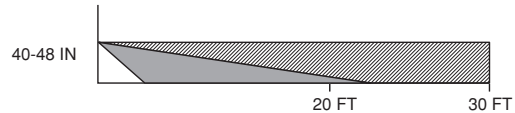

What to do if...

Issue	Make this adjustment
Lights do not operate with push pad and RED indicator does not blink when motion is present.	<ul style="list-style-type: none"> • Verify wiring connections to sensor. • Make sure that control is installed correctly. • Make sure the power is ON. • Check to make sure the light bulb is functional.
Lights do not switch ON when motion is detected (DOS02).	<ul style="list-style-type: none"> • Motion is beyond sensing range - move closer to switch. • Adjust the ambient light level lower (Option 3, 2, 1 or disable). The RED light will blink to indicate motion. If it is blinking and the load is not turning ON, it could be due to ambient light. • Check to make sure that the Occ-Vac switch is in OCC position.
Lights always stay ON	<ul style="list-style-type: none"> • Check time delay settings and compare to how long the lights stay ON. • Make sure no motion occurs in coverage area for time selected by covering the lens. • Check that switch is not installed near a heat source (like stove, lights, heat vents) or detecting motion from an adjacent area (like hallway traffic) and if it is, relocate it.

Scan this code with your cell phone camera to watch a video on how to program the settings on the Leviton Decora Motion Sensor light switch.



Patents covering this product, if any, can be found on www.leviton.com/patents.

Leviton, the Leviton logo and Decora are the registered trademarks of Leviton Mfg. Co., Inc.

FCC AND INDUSTRY CANADA COMPLIANCE STATEMENT: This device complies with Part 15 of the FCC Rules and ISED License-exempt RSS standard(s). Operation is subject to the following two conditions: (1) This device may not cause harmful interference, and (2) This device must accept any interference received, including interference that may cause undesired operation. Changes or modifications not expressly approved by the party responsible for compliance could void the user's authority to operate the equipment. To comply with FCC/ISED RF exposure limits for general population / uncontrolled exposure, the antenna(s) used for this transmitter must be installed to provide a separation distance of at least 20 cm from all persons and must not be co-located or operating in conjunction with any other antenna or transmitter different from that to which the receiver is connected.

FCC CAUTION: Any changes or modifications not expressly approved by Leviton Manufacturing Co., Inc., could void the user's authority to operate the equipment.

FOR CANADA ONLY

For warranty information and/or product returns, residents of Canada should contact Leviton in writing at Leviton Manufacturing of Canada Ltd to the attention of the Quality Assurance Department, 165 Hymus Blvd, Pointe-Claire (Quebec), Canada H9R 1E9 or by telephone at 1-800-405-5320.

LIMITED 5 YEAR WARRANTY For Leviton's limited product warranty, go to www.leviton.com. For a printed copy of the warranty, call 1-800-824-3005.

For Technical Assistance Call: 1-800-824-3005 (USA Only) or 1-800-405-5320 (Canada Only) www.leviton.com