

Getting Started Guide



ELV/LED DIMMER

READ THESE INSTRUCTIONS BEFORE INSTALLING

Easy Wi-Fi lighting control for the whole home.



See the complete line of My Leviton™ app compatible dimmers, switches, plug-ins, and controllers at: my.leviton.com

Welcome



Leviton's Decora Smart Wi-Fi ELV/LED Phase Selectable Dimmer makes it easy to add smart dimming control to Electronic Low-Voltage lighting, such as undercabinet, toe kick, track lighting, and accent lighting. The dimmer includes bulb compatibility options via the My Leviton app to fine tune performance such as forward and reverse phase selection, minimum dim/maximum bright settings, fade on/fade off, and more.

Using the My Leviton app, it is also easy to schedule or remotely control connected lighting and include lighting in scenes and activities.

Connect to your smart home platform of choice - your Wi-Fi ELV/LED Dimmer works with Matter, Amazon Alexa, Google Home, Apple Home/Siri, and more.

We are here to help

- ONLINE**
decorasmartsupport.leviton.com
- CHAT**
www.leviton.com/support
- EMAIL**
dssupport@leviton.com
- CALL**
1-800-824-3005 (USA)
1-800-405-5320 (Canada)

Dimmer specifications

- Works with electronic low-voltage, dimmable LED, dimmable CFL, and incandescent lighting.
- Do not use your dimmer with magnetic low-voltage lighting or motor loads.
- Not for use with aluminum wire.
- Installation in metal wall boxes or with metal wall plates may result in poor RF performance.
- When two or more dimmers are installed next to each other, the load ratings become 500W incandescent or 500W ELV for each dimmer. No reduction is necessary if the load is LED or CFL.
- Indoor Use only.
- For compatible LED bulbs, go to leviton.com/LED
- Self-service support options can be found in the My Leviton app or at my.leviton.com**

RATINGS	
Electronic Low-Voltage	600VA/5A, 120VAC, 60Hz
LED / CFL	300W/2.5A, 120VAC, 60Hz
Incandescent / Halogen	600W, 120VAC, 60Hz
Operating Temperature	32°F to 104 °F (0 °C - 40 °C)
Operating Humidity	10% - 90% non-condensing
NETWORK	
Wi-Fi	802.11 b/g/n networks - 2.4 GHz only
Security	WPA, WPA2, or WPA3 security, or open
Bluetooth	v5.0
MY LEVITON APP	
iOS	Version 12.0 or later
Android™	Version 8.0 or later

At a glance

-
- Dim / bright bar**
Manually adjust light levels.
 - Rocker**
 - Press the top to turn the light ON.
 - Press the bottom to turn the light OFF.
 - Double press the top turn ON at max brightness.
 - Off means off**
 - Ensures low-wattage LED bulbs always turn OFF.
 - Brightness indicator lights**
 - Displays light level when adjusting brightness.
 - Status LED**
 - Illuminates when the lights are OFF so you can find the dimmer in the dark.
 - Provides connectivity and device status feedback.
 - Advanced settings available in the My Leviton app.
 - Air gap switch**
This feature will stop power to the dimmer. Gently pull bottom out until a click is heard. Power to the dimmer and indicator lights will turn off. After servicing is complete, push back in for normal operation.

DI-000-D2ELV-02C

Cat. No. D2ELV

FCC COMPLIANCE STATEMENT
The enclosed device complies with Part 15 of the FCC Rules. Operation is subject to the following two conditions: (1) This device may not cause harmful interference (ii) This device must accept any interference received, including interference that may cause undesired operation. Any changes or modifications not expressly approved by Leviton could void the user's authority to operate this equipment. This equipment has been tested and found to comply with the limits for a Class B digital device, pursuant to part 15 of the FCC Rules. These limits are designed to provide reasonable protection against harmful interference in a residential installation. This equipment generates uses and can radiate radio frequency energy and, if not installed and used in accordance with the instructions, may cause harmful interference to radio communications. However, there is no guarantee that interference will not occur in a particular installation. If this equipment does cause harmful interference to radio or television reception, which can be determined by turning the equipment off and on, the user is encouraged to try to correct the interference by one or more of the following measures:

- Reorient or relocate the receiving antenna.
- Increase the separation between the equipment and receiver.
- Connect the equipment into an outlet on a circuit different from that to which the receiver is connected.
- Consult the dealer or an experienced radio/TV technician for help.

FCC CAUTION
Any changes or modifications not expressly approved by Leviton Manufacturing Co., Inc., could void the user's authority to operate the equipment.

FCC SUPPLIER'S DECLARATION OF CONFORMITY
Model D2ELV - Decora Smart Wi-Fi ELV Dimmer is manufactured by Leviton Manufacturing Co., Inc. 201 N. Service Road, Melville, NY 11747. www.leviton.com This device complies with part 15 of the FCC Rules. Operation is subject to the following two conditions: (1) This device may not cause harmful interference, and (2) this device must accept any interference received, including interference that may cause undesired operation.

IC STATEMENT
This device complies with Industry Canada license-exempt RSS standard(s). Operation is subject to the following two conditions: (1) This device may not cause interference, and (2) this device must accept any interference, including interference that may cause undesired operation of the device.

RF EXPOSURE AND CO-LOCATION
To comply with FCC OET Bulletin 65 and ICESB RF exposure limits for general population and uncontrolled exposure, this device shall be installed and operated with a minimum distance of 7.9 inches (20 cm) between the radiator and your body. Also, must not be co-located or operated in conjunction with any other antenna or transmitter.

PATENT STATEMENT
Patents covering this product, if any, can be found on Leviton.com/patents

Copyright and Trademark Information
Decora and Decora Smart are the registered trademarks of Leviton Manufacturing Co., Inc., registered in the U.S., Canada, Mexico and China. Google, Android, Google Play and Google Home are trademarks of Google LLC. Alexa, and related logos are trademarks of Amazon.com, Inc. or its affiliates. Apple®, Apple Home®, and Siri® are trademarks of Apple Inc., registered in the U.S. and other countries. Matter, FITT and the Wi-Fi CERTIFIED logo are trademarks of their respective owners and any use of such marks by Leviton is under license. Use of the Works with Apple badge means that an accessory has been designed to work specifically with the technology identified in the badge and has been certified by the developer to meet Apple performance standards. Apple is not responsible for the operation of this device or its compliance with safety and regulatory standards. Use herein of other third party trademarks, service marks, trade names, brand names and/or product names are for informational purposes only, are/may be the trademarks of their respective owners; such use is not meant to imply affiliation, sponsorship, or endorsement. No part of this document may be reproduced, transmitted or transcribed without the express written permission of Leviton Manufacturing Co., Inc. Leviton Manufacturing Co., Inc. 201 North Service Road, Melville, NY 11747 © 2024 Leviton Manufacturing Co., Inc. All rights reserved. Specifications subject to change at any time without notice.

Features

- On/Off and Dim/Bright control of ELV, LED, CFL, and Incandescent lighting.
- "Off means Off" ensures low-wattage LED bulbs always turn off.
- Supports 3-Way/Multi-location with Wired Companions and Wireless Anywhere Companions.
- Compatible with DDKIT color change kits.
- Customizable dimmer settings for:
 - Bulb types including non-dimmable loads.
 - Dimming mode (Reverse/Forward phase selection).
 - Minimum dim/Maximum brightness.
 - Fade rates.
 - Pre-set light level or Return to last level.

NOTE: Dimmer settings can be configured using the My Leviton app or at the device using a simple button interface, to learn more visit decorasmartsupport.leviton.com

For more information and features visit: my.leviton.com

Before you install

Installation requires electrical knowledge. If you are unsure of any steps, consult an electrician.

Things to consider:
To control from more than one location, such as in a 3-way or multi-way, you need either a wired DD00R or DD0SR Companion device, or a wire-free DAWDC or DAWSC Anywhere Companion device (see page 15). Learn more about Companion devices and find connection instructions at my.leviton.com

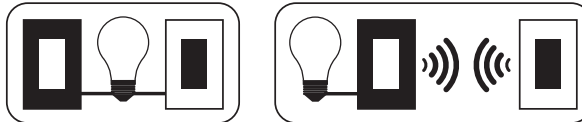

What you need to make it work:

- A 2.4 GHz Wi-Fi network with high-speed internet.
- An iOS (12.0 or later) or Android™ (8.0 or later) mobile device.
NOTE: Make sure Wi-Fi and Bluetooth are enabled on your mobile device.
- A My Leviton account, if connecting using the My Leviton App.
- A Matter controller or hub, if connecting using Matter.

Identify your wires

WARNING: TO AVOID FIRE, SHOCK OR DEATH, turn off power at the circuit breaker.

- Check your wallbox:**
- Remove wallplate and disconnect existing switch.
 - Restore power. Carefully test wires with voltage tester to find the line (hot) wire.
 - Turn off power at the circuit breaker.**
 - Mark the wires as shown below. Please note neutral wires are required to operate this device.
- Quick tip:** Neutral wires are typically WHITE and will be found bundled inside the electrical box.

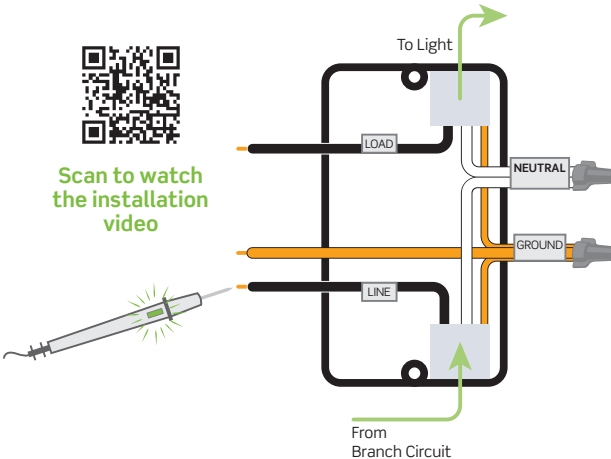

If your wallbox looks different, call an electrician.

Wire your dimmer

- Single pole installation:**
- Work only one connection at a time.
 - Connect wires as shown using the included wire connectors.
- NOTE:**
- Neutral connection is required.
 - The YELLOW/RED traveler wire is only used in 3-way applications; remember to put a wire connector on the YELLOW/RED traveler even if not in use.

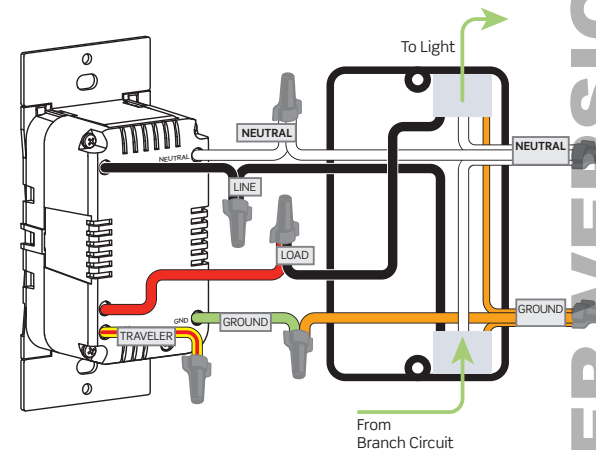

If your wallbox contains a different wiring configuration, contact Leviton's technical support team, or consult an electrician.

WEB VERSION

Test and install

1. Restore power. Status LED should flash GREEN indicating your dimmer is ready to be enrolled.
2. After powering on the dimmer to confirm it is receiving power, turn the power back off again at the breaker prior to completing the installation.

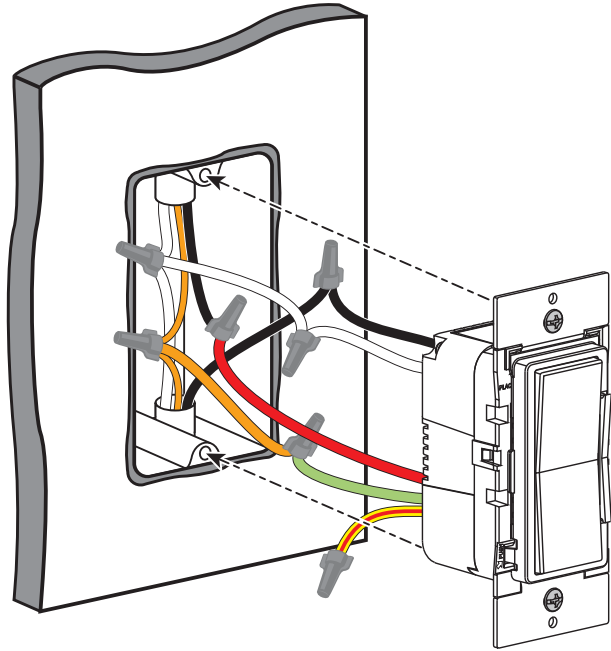

9

Test and install (continued)

Turn off power at the circuit breaker before screwing in your dimmer.

3. Gently push wires into wallbox. Screw dimmer to box.

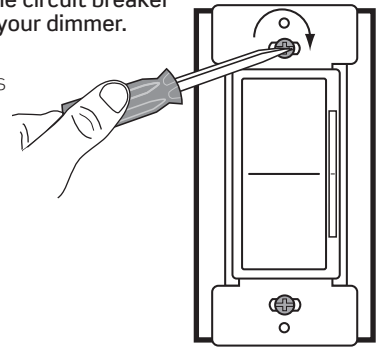

4. Snap on Decora® wallplate and restore power.

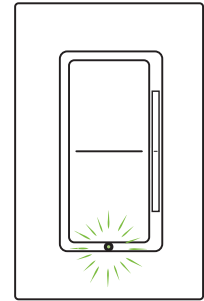

Once power is restored, the status LED will blink GREEN indicating your device is in setup mode. See page 16 if your Status LED is not blinking GREEN.

Congratulations
Your Decora Smart Dimmer is ready to control your light.

10

Device setup

- Your Decora Smart Wi-Fi ELV/LED Dimmer can be connected to the My Leviton cloud (see page 12), to Matter using a compatible Matter controller or Hub (see page 14), or to both.
- For voice control with Amazon Alexa, you can set up your device with My Leviton and link your Amazon Account, or you can use Matter to set it up directly in the Amazon Alexa app if you have a compatible Matter-enabled Amazon device.
- For voice control with Google Assistant-enabled devices, you can set up your device with My Leviton and link your Google Account, or you can use Matter to set it up directly in the Google Home app if you have a compatible Matter-enabled Google device.
- For voice control with Siri, use Matter to set up your device directly in the Apple Home app; controlling this Matter-certified accessory with the Apple Home App and Siri requires an Apple Home hub such as HomePod or Apple TV running the latest software.
- For use with Samsung SmartThings, use Matter to set up your device in the SmartThings app and connect to a compatible Matter-enabled SmartThings Hub



11

Get the app

To download the My Leviton app, visit my.leviton.com and select the link or scan the QR code below for your device.



Add your device to My Leviton

1. Make sure the device is in setup mode (status LED should be blinking GREEN). If the status LED is not blinking GREEN, see page 16 for instructions on how to put the device in setup mode.
2. Launch the My Leviton app.
3. Log in or choose "Sign Up" for an Account.
4. Follow the instructions on the screen.
5. Once logged in, tap the "+" in the upper-right corner of the devices page and select "Add Device".
6. Follow the app instructions to add your device and connect it to your home Wi-Fi network.

12

Test My Leviton app control

1. Open the My Leviton app.
2. Tap icon to turn ON/OFF.

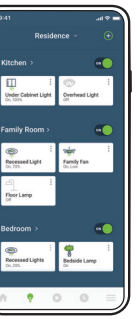

Quick tip:

- The My Leviton app includes many features such as: scheduling, remote control, vacation mode, auto-shutoff, room scenes, and advanced options for bulb type, fade rates, preset light level, and minimum dim/maximum brightness.

- Additional self-service support options can be found in the My Leviton app or at my.leviton.com

Dimming mode

The Decora Smart Wi-Fi ELV/LED Dimmer is designed for use with Electronic Low Voltage lighting (ELV) out of the box and uses reverse phase dimming by default. For bulb compatibility, to alternatively select LED lighting and forward phase dimming at the device:

1. Press the top rocker 7 times in sequence.

2. The device will change mode and the status LED will briefly flash:

- GREEN, if in ELV/reverse phase mode.
- RED, if in LED/forward phase mode.

NOTE: You can also use the My Leviton app to adjust settings including additional bulb type and dimming options.

13

Connect to a Matter Controller (optional)

1. Make sure the device is in Setup Mode (Status LED should be blinking GREEN). If the Status LED is not blinking GREEN, see page 16 for instructions on how to put the device into setup mode.
2. Using a mobile device, open the Matter Controller's app and select "Add Accessory" or "Add Device".
3. Locate and scan the Matter Setup code on the device or on the front page of this Getting Started Guide. If your device has already been enrolled to My Leviton, you can retrieve the Matter Setup code at any time under "Device Settings" in the My Leviton app.
4. Follow the instructions in the Matter Controller's app to complete the setup process and control your Decora Smart device using Matter.

If connecting to more than one Matter Controller:

- The Matter Setup Code on the first page of this manual, on the device, and in the My Leviton app can only be used for setup if the device is not already commissioned to a Matter controller.

- If the Status LED briefly blinks AMBER when the device is put into Setup Mode, the device is already commissioned to a Matter Controller.

- To add the device to additional Matter controllers, use the Matter controller's app the device is already connected with to generate a new single use Matter pairing code.

- To delete all Matter connections, factory default the device (see page 16). The Matter Setup Code on the first page of the manual, on the device, and in the My Leviton app can now be used again for commissioning.

14

Pair an Anywhere Companion (optional)

1. Place the Anywhere Companion in Pairing mode by pressing the top rocker 5 times. Its Status LED will blink GREEN.
2. Place the primary Decora Smart Wi-Fi Dimmer into Pairing mode by pressing the top rocker 5 times. The Status LED will flash GREEN/AMBER.
3. The Decora Smart Wi-Fi Dimmer will automatically pair to the Anywhere Companion in Pairing mode in wireless RF range. Once paired, the Status LED will quickly flash GREEN to show a successful connection.

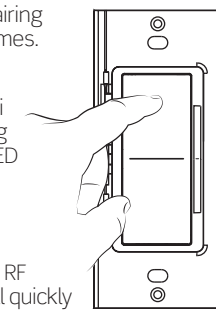

Learn more about Companion devices and find connection instructions at Leviton.com/anywhere

Diagnostic LED

If your device is not connecting to the My Leviton app, the Status LED can be used as a diagnostic tool. Press the button for at least 2 seconds (but no more than 7 seconds), and then release. The status LED blinks a diagnostic code for 2 seconds.

COLOR	STATUS
AMBER	Not connected to Wi-Fi.
RED	Connected to Wi-Fi, but not able to connect to the My Leviton cloud.
GREEN/AMBER, Alternating	Connected to Wi-Fi and My Leviton cloud, but unable to set the time from the internet.
GREEN	Connected to Wi-Fi and My Leviton cloud is working properly.

15

Status LED

COLOR	ACTIVITY	STATUS
GREEN	Flashes	In Setup Mode and ready to be added to a Wi-Fi network.
GREEN	Slow Blink	Connecting to a Wi-Fi network on power up.
GREEN or Off	Solid	Normal operation, can be configured in Setup Mode.
AMBER	Slow Blink	Device is not connected to the Wi-Fi network, but attempting to reconnect.
GREEN/AMBER	Alternating Blink	Device is in wireless Anywhere Companion Pairing Mode.
RED	Blinks	Wireless Anywhere Companion devices have unpaired or at max number of paired devices.
GREEN/RED/AMBER	Alternating Blink	Identify feature triggered from the My Leviton app.

Visit My.Leviton.com and select the "Support" option for additional diagnostic assistance.

Setup mode

1. Hold the top rocker for 7 seconds until the status light turns AMBER, then release.
2. The status LED will flash GREEN. The device is now in Setup Mode.



Factory default reset

1. Hold the top rocker for a total of 14 seconds.
 - After the first 7 seconds the status LED will turn AMBER. Continue to hold.
 - After a total of 14 seconds, the status LED will quickly flash RED/AMBER.
2. Release the top rocker and the device will reset.

16

What to do if...

When power is applied, the light turns on, but the dimmer is not able to change the light level:

- For proper operation, the dimmer needs a line (hot), neutral, load, and ground connection.
- Confirm the WHITE conductor is a neutral.
- If using LED or CFL bulbs, make sure they are dimmable.

The dimmer does not dim low enough or begins to flicker:

- Use the My Leviton app to increase the minimum dim level to the point that it does not cause the light to flicker.
- Make sure the wires are secured firmly with wire connectors.
- Confirm the load type or change dimming mode between forward and reverse phase.

Light does not turn on:

- Circuit breaker or fuse has tripped.
- Neutral not wired to dimmer (WHITE wire).
- Confirm that the device is being supplied from a 120V, 60Hz AC source ONLY.

Intermittent dimmer operation:

- Confirm the load does not exceed its ratings.

Not connected to Wi-Fi:

- Use the My Leviton app and navigate to the "Device Settings" screen, select "Reconfigure Wireless".
- Follow the prompts to reconfigure your device and update the Wi-Fi settings.

How do I clean my device?

- To clean, use a damp cloth with mild soap. DO NOT use disinfecting products, including foggers, sprays or other types of atomized cleaning agents.

Visit my.leviton.com or contact technical services for additional help

17

Safety first

WARNINGS:

- **TO AVOID FIRE, SHOCK, OR DEATH; TURN OFF POWER** at circuit breaker or fuse and test that power is off before wiring
- **TO AVOID FIRE, PERSONAL INJURY OR PROPERTY DAMAGE, DO NOT** install to control a receptacle, a motor, or a transformer-operated appliance.
- To be installed and/or used in accordance with electrical codes and regulations.
- For indoor use only.
- If you are unsure about any part of these instructions, consult an electrician.

CAUTIONS:

- Use with compatible 120V dimmable LED/CFL bulbs, incandescent, halogen or electronic low-voltage (ELV, solid state) transformers only. DO NOT use with magnetic-low-voltage (MLV) fixtures/transformers. For a list of compatible bulbs refer to www.leviton.com/LED
- DO NOT mix bulb types when multiple bulbs are used with one dimmer. Using the same make/model of each bulb will enhance dimmer performance.
- The Decora Smart D2ELV dimmer is not compatible with standard 3-way or 4-way switches. It must be used with up to 4 Decora Smart DD00R-DL or DD00R companions for wired multi-location dimming.
- Maximum wire length from dimmer to all installed companion devices cannot exceed 300 ft (90 m)
- Save this instruction sheet. It contains important technical data along with testing and troubleshooting information which will be useful after installation is complete.
- Dimmer may feel warm to the touch during normal operation.
- Recommended minimum wallbox depth is 2-3/4 in.
- Use this dimmer with copper or copper-clad wire only.
- Leviton Wi-Fi enabled devices rely on Wi-Fi communication. For customers looking to install a large number of devices it is recommended to consult the wireless network's access point specifications to determine the maximum number of supported Wi-Fi devices. In some cases, for example large installations, it may be necessary to upgrade to newer high performance wireless grade access points to ensure proper operation.

ADDITIONAL RATINGS:

- Purpose of control: Operating Control
- Impulse Voltage: 2,500V
- Action Control Type: 1
- Disconnection Type: Micro
- Pollution Degree: 2

Limited 1 Year Warranty & Exclusions

For Leviton's limited product warranty, go to www.leviton.com. For a printed copy of the warranty, call 1-800-824-3005.

FOR CANADA ONLY

For warranty information and/or product returns, residents of Canada should contact Leviton in writing at Leviton Manufacturing of Canada ULC to the attention of the Quality Assurance Department, 165 Hymus Blvd, Pointe-Claire (Quebec), Canada H9R 1E9 or by telephone at 1-800-405-5320.

WEB VERSION