

PRODUCT SPECIFICATIONS

E2X1F-E48, E2XHD-BLK, E2X1F-CMB, E2XHD-LBL, E2XHD-BRK

e2XHD High-Density Universal Flat Panels & Accessories (For customers in Europe and the Middle East)

APPLICATION

The e2XHD Patching System provides a high-density solution for enterprise and data center applications where fast deployment and simple maintenance are priorities. Cassettes (sold separately) quickly snap-in and pull out of 1RU panels, making installation, moves, adds, and changes easier than ever. A rear cable manager is available to support incoming fiber and copper cables, and blank cassettes snap into the rear of panels to block any unused openings. Copper cassettes are available either on pre-terminated trunks or with field-terminated connectors. Fiber cassettes are pre-terminated.



e2XHD Flat Panel - 1RU



Rear Cable Manager for flat panels



Blank Cassette



e2XHD Label Kit

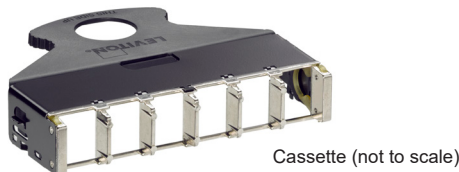

Cassette (not to scale)

SPECIFICATION

Panels shall be constructed of 20-gauge steel with a black powder-coated finish. Port identification shall be included. Panels shall accept shielded, unshielded, and fiber e2XHD cassettes, and hold up to 48 duplex fiber channels or 48 copper ports in a 1RU space. Copper and fiber cassettes shall snap into the rear of the panel and shall require no tools to remove.

FEATURES & BENEFITS

- Panels allow mix-and-match of shielded, unshielded, and fiber e2XHD cassettes
- Alignment tabs ensure upright insertion of cassettes
- To remove cassettes from panel, simply pull out handle using release latch
- Rear Cable Manager supports incoming copper or fiber cables and includes cable management rings
- Blank cassette available for unused cassette openings

DESIGN CONSIDERATIONS

- Rear cable manager sold separately from panel
- Panels mount on standard 19-inch cabinet
- Cable clamp mounting kits are available to provide strain relief for incoming fiber trunk cables
- When routing copper cable, one Rear Cable Manager is recommended for every 2RU of panel to allow for better rear access
- Panels include M5 cage nuts and screws, as well as appropriate parts for bonding panels to cabinets

MECHANICAL SPECIFICATIONS

Dimensions:	See page two
Material:	20-gauge steel, powder-coated black
Capacity:	1RU: 48 duplex fiber channels or 48 copper ports 1RU: Accepts up to 8 copper and/or fiber cassettes (12-fiber LC-MTP®, 24-fiber MTP-MTP), or 4 24-fiber LC-MTP cassettes

COUNTRY OF ORIGIN

USA:	E2XHD-BLK, E2XHD-LBL
Mexico:	E2X1A-CMB, E2XHD-COV
Taiwan:	E2X1F-E48
China:	E2XHD-BRK

WARRANTY INFORMATION

For Leviton product warranties, go to Leviton.com/ns/warranty

E2X1F-E48, E2XHD-BLK, E2X1F-CMB, E2XHD-LBL, E2XHD-BRK

PRODUCT SPECIFICATIONS

E2X1F-E48, E2XHD-BLK, E2X1F-CMB, E2XHD-LBL, E2XHD-BRK

E2X1F-E48, E2XHD-BLK, E2X1F-CMB, E2XHD-LBL, E2XHD-BRK

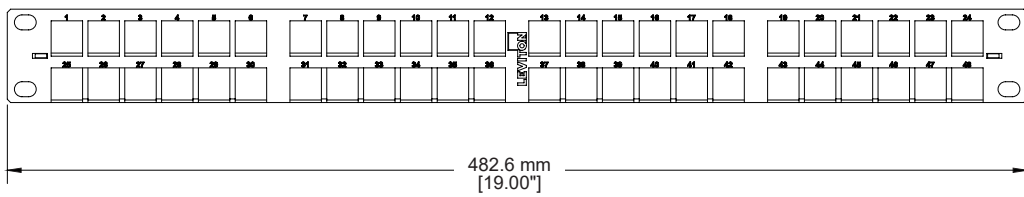
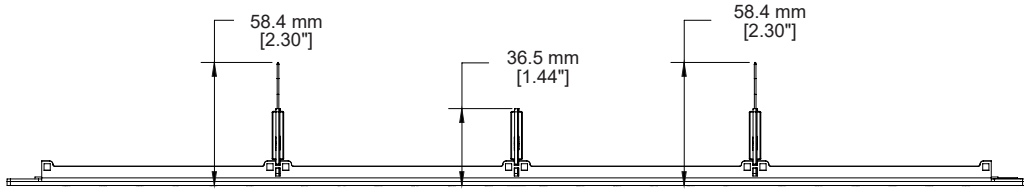

1RU Flat Panel

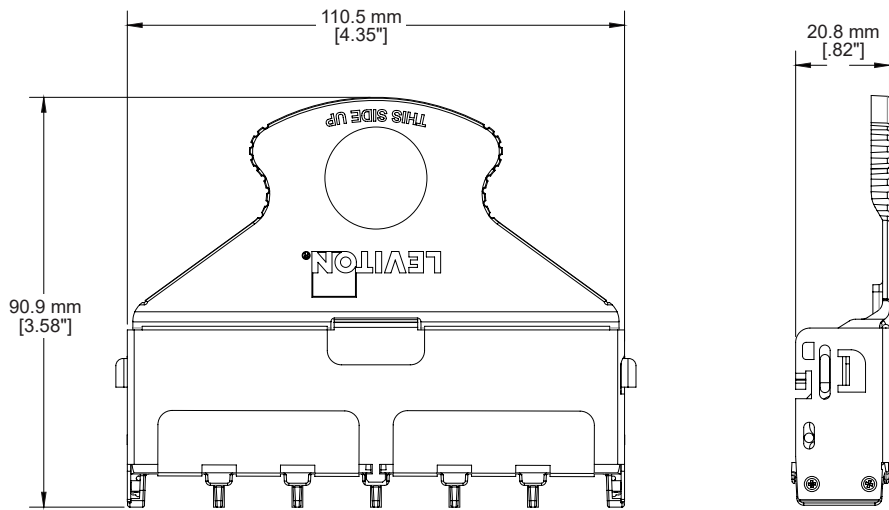
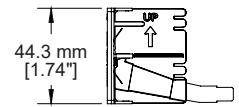

e2XHD Cassette

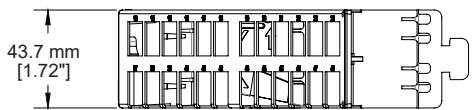

1RU Panel — Side View

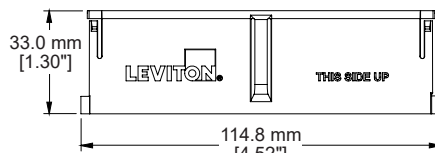

e2XHD Cassette Blank

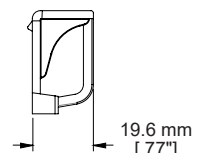

PRODUCT SPECIFICATIONS

E2X1F-E48, E2XHD-BLK, E2X1F-CMB, E2XHD-LBL, E2XHD-BRK

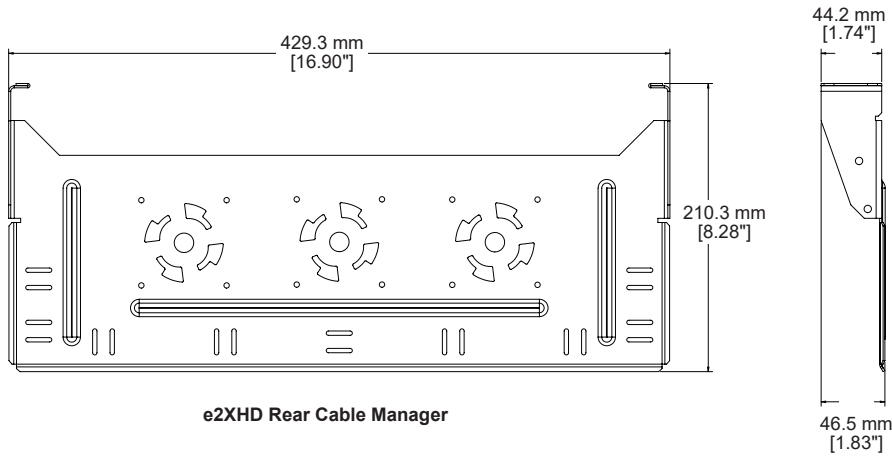

E2X1F-E48, E2XHD-BLK, E2X1F-CMB, E2XHD-LBL, E2XHD-BRK

E2XHD PATCHING SYSTEM

Description	Part No.
e2XHD 1RU High-Density Universal Flat Panel, accepts shielded, unshielded, and fiber cassettes	E2X1F-E48
e2XHD Rear Cable Manager for flat panels, includes four 1/4" round cable management rings	E2X1F-CMB
e2XHD Cassette Blank	E2XHD-BLK
e2XHD Label Kit	E2XHD-LBL
e2XHD Empty Cassette	E2XHD-BRK

E2XHD RELATED PRODUCTS

Description	Part No.
Universal 0RU Patch Cord Cable Manager (bag of 2)	5RCMT-VFG
Universal 1RU Patch Cord Cable Manager Tray	5R1UX-CMT
Universal 2RU Patch Cord Cable Manager Tray	5R2UX-CMT
Universal Opt-X™ Clamp Kit, single cable grommet (mounts to Rear Cable Manager)	5RCMP-KIT
Universal Opt-X Clamp Kit, multiple cable grommet (mounts to Rear Cable Manager)	5RCMP-KT2
Universal Clamp Kit, single and multiple cable grommet (for rack mounting)	5RCMR-KIT

For further support information, visit Leviton.com/ns/support