

Cat 6A UTP Flat 110-Style Patch Panels

APPLICATION

Cat 6A UTP Flat 110-Style Patch Panels are designed for use with industry-standard 19-inch racks and cabinets for telecommunication room and data center applications. Patch panels exceed all component performance requirements in the ANSI/TIA-568.2-D standard and the Class E_A component requirements for the ISO/IEC 11801-1 and EN 57013-1 standards from 1 MHz to 500 MHz to support the IEEE 802.3an standard for 10GBASE-T network performance. Patch panels feature industry-standard, in-line IDCs and are component rated, which provides greater Cat 6A performance margins in link and channel field testing.



SPECIFICATION

The UTP patch panels shall meet all requirements for Cat 6A component performance as defined in ANSI/TIA-568.2-D ISO/IEC 11801-1, and EN 57013-1, and meets IEEE 802.3an requirements for 10GBASE-T. Panels shall feature industry-standard, in-line 110 insulation displacement connectors (IDCs) and separated six-pack IDC blocks. 110 IDCs shall include conductor retention features and pair separation towers designed specifically for large conductor size in Cat 6A cable. The 110-style termination shall allow the installer to terminate and cut the wires in one action. Patch panels shall be available in 24- and 48-port configurations. Patch panels shall not require a separate termination manager. Panels shall have a black powder-coated finish with white silk-screened port numbers and include magnifying lens label holders for optimal label visibility in all lighting conditions.

COUNTRY OF ORIGIN

Please contact Customer Service

WARRANTY INFORMATION

For Leviton product warranties, go to Leviton.com/ns/warranty

FEATURES & BENEFITS

- Independently tested and verified by Intertek (ETL) for Cat 6A component performance
- 110 IDC termination fields support 26 to 22 AWG solid copper conductors
- Conductor-retention feature holds individual conductors in place during termination
- Pair Separation Towers facilitate separation of Cat 6A conductors
- Separated blocks provide room to work with larger Cat 6A cables and help to identify first-pair position
- Terminates up to 50% faster than Cat 6A panels requiring additional termination manager
- Reversible card shows T568 A and B wiring schemes separately
- Industry-standard port density: 24-port 1RU and 48-port 2RU
- IDC stuffer caps provide termination strain relief

DESIGN CONSIDERATIONS

- Mounts on 19-inch equipment racks
- Panel offered in 24- and 48-port configurations
- Magnifying label holders adjacent to connectors
- One tool-free Cable Management Bar (CMB) included per rack unit

STANDARDS & REGULATIONS

- ANSI/TIA-568.2-D component requirements for connecting hardware from 1 MHz to 500 MHz
- ISO/IEC 11801-1 Class E_A
- EN 57013-1
- c(UL)us listed
- ANSI/TIA-1096-A (formerly FCC Part 68)
- IEEE 802.3an to support 10GBASE-T networks
- IEEE 802.3 PoE Type 1, 2, 3, 4 (100 watts max)
- Cisco UPOE, UPOE+ (90 watts max)
- Power over HDBaseT™ PoH (95 watts max)

MECHANICAL SPECIFICATIONS

Dimensions: See page 2
Materials: 16-gauge steel, black powder-coat, PCB and plastic components are UL94V-0

Temp. (Storage): -40 °C to +70 °C (-40 °F to +158 °F)
Temp. (Installation): Refer to cable installation temperature
Temp. (Operating): -10 °C to +60 °C (+14 °F to +140 °F)
Humidity (Max.): 95% relative humidity, non-condensing

PRODUCT SPECIFICATIONS
6A586-U24, 6A586-U48

6A586-U24

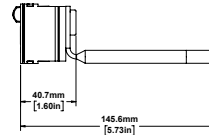
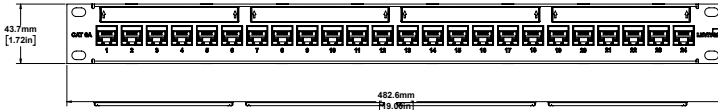

6A586-U48

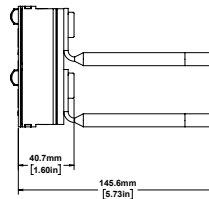
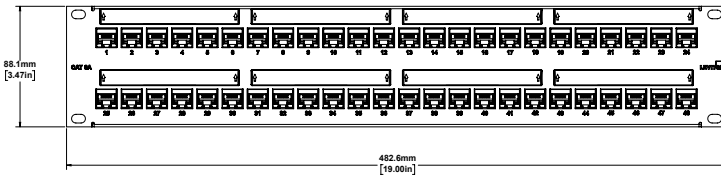

ANSI/TIA-568.2-D CAT 6A PARAMETERS	CONNECTING HARDWARE REQUIREMENTS* (DB)		
Description	@ 100MHz	@ 250MHz	@ 500MHz
Insertion Loss (IL)	0.20	0.32	0.45
Near-end Crosstalk (NEXT)	54.0	46.0	34.0
Far-end Crosstalk (FEXT)	43.1	35.1	29.1
Return Loss (RL)	28.0	20.0	14.0
Transverse Conversion Loss (TCL)	28.0	20.0	14.0
Transverse Conversion Transfer Loss (TCTL)	28.0	20.0	14.0
Power sum Alien Near-end Crosstalk (PSANEXT)	67.0	62.5	56.5
Power sum Alien Far-end Crosstalk (PSAFEXT)	67.0	59.0	53.0

*Notes: All requirements are minimum allowable, except IL are maximum allowable. Connecting hardware shall meet requirements of all parameters from 1-500MHz. Values in above table are only at specific frequencies and are for reference only.

PART NUMBERS	
Description	Part No.
Cat 6A UTP Flat 110-Style Patch Panel, 1RU, 24-Port, with cable management bar, black	6A586-U24
Cat 6A UTP Flat 110-Style Patch Panel, 2RU, 48-Port, with 2 cable management bars, black	6A586-U48

For further support information, visit Leviton.com/ns/support