

Passive Video Splitters and Splitter Modules

APPLICATION

6- and 8-way Passive Video Splitters and Passive Video Splitter Modules are ideal for splitting digital cable, quality cable TV, and off-air signals to six or eight televisions throughout a home or office. Passive Video Splitter Modules are designed for easy installation in any Leviton 14", 21", 28", or 42" STRUCTURED MEDIA™ Center. Passive Video Splitters are easily installed in Leviton MDU Enclosures or used in any application where a passive video splitter is needed. These units feature die-cast housings and printed circuit board construction.



SPECIFICATION

Passive Video Splitter Modules shall be mounted in any Leviton 14", 21", 28", or 42" STRUCTURED MEDIA Center, used in any application where a passive video splitter is required.

FEATURES & BENEFITS

- Split video signals with outputs for six or eight televisions
- Provide digital cable, cable TV, and other video services via coaxial cable to any room in a house or office
- Durable gold-plated 360-degree insert pin resists oxidation, maintaining a distortion-free signal for digital data transmission
- Weather sealed F-ports up to 30 PSI
- 75 Ohm termination caps with splitter modules
- 6kV surge protection
- Built-in capacitors on all ports block DC or low-frequency AC and also prevent current from flowing through splitter's ferrite core windings that cause hum modulation
- High-quality plating passes 1200-hour salt spray test
- Maintains low temperature stability from -40 °C to +85 °C both in isolation and return loss

DESIGN CONSIDERATIONS

- Passive Video Splitter Modules come with mounting bracket for easy installation in any Leviton 14", 21", 28", or 42" STRUCTURED MEDIA Center
- Passive splitters without a bracket are easily installed in Leviton MDU Enclosures (47605-MDU)
- Can be used with a video amplifier for increased signal quality
- High-precision machined, SCTE-compliant threaded ports spaced at intervals of one inch, center to center
- Printed circuit board construction
- Shielded for -130 dB RFI

STANDARDS COMPLIANCE

- SCTE
- ATIC listed
- MoCA compatible

MECHANICAL SPECIFICATIONS

Dimensions: See page 2
 Materials: **Splitter:** Nickel-plated F-connector, tin-plated zinc die-cast housing, and glass-printed circuit board with micro-strip design
Bracket: White powder-coated 18-gauge sheet metal

COUNTRY OF ORIGIN

China

WARRANTY INFORMATION

For Leviton product warranties, go to Leviton.com/ns/warranty

47690-xC2, 47690-0Gx

PRODUCT SPECIFICATIONS
47690-xC2, 47690-0Gx

47690-xC2, 47690-0Gx

47690-6C2

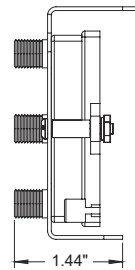
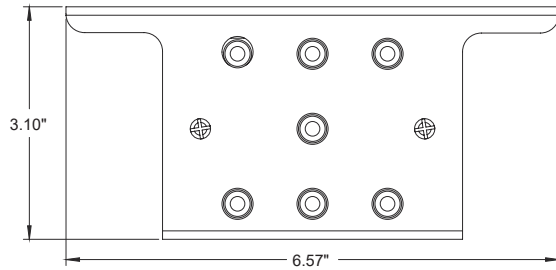

47690-8C2

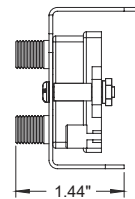
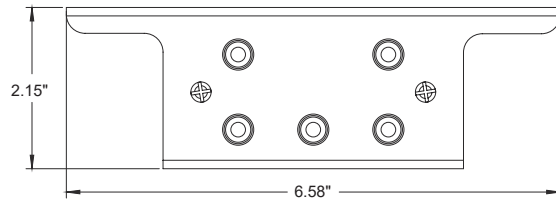

47690-0G6

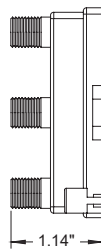
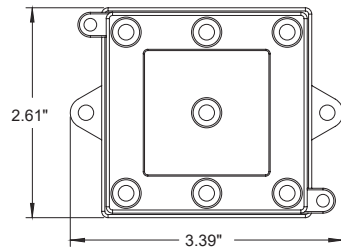

47690-0G8

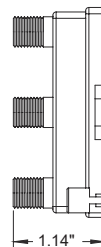
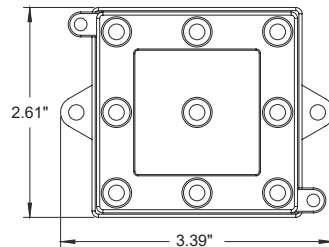

PRODUCT SPECIFICATIONS
47690-xC2, 47690-0Gx

47690-xC2, 47690-0Gx

PERFORMANCE SPECIFICATIONS		
Insertion Loss	1x6	1x8
5 MHz – 47 MHz	-10.5 dB	-13.0 dB
47 MHz – 950 MHz	-12.5 dB	-13.0 dB
950 MHz – 1450 MHz	-13.0 dB	-14.0 dB
1450 MHz – 2050 MHz	-14.5 dB	-15.5 dB
2050 MHz – 2150 MHz	-16.0 dB	-16.5 dB
Input Return Loss	1x6	1x8
5 MHz – 47 MHz	-11.0 dB	-8.5 dB
47 MHz – 950 MHz	-13.0 dB	-13.0 dB
950 MHz – 1450 MHz	-13.0 dB	-13.0 dB
1450 MHz – 2050 MHz	-13.0 dB	-13.0 dB
2050 MHz – 2150 MHz	-13.0 dB	-13.0 dB
Isolation Loss	1x6	1x8
5 MHz – 47 MHz	-21.0 dB	-21.0 dB
47 MHz – 950 MHz	-21.0 dB	-21.0 dB
950 MHz – 1450 MHz	-20.0 dB	-21.0 dB
1450 MHz – 2050 MHz	-20.0 dB	-21.0 dB
2050 MHz – 2150 MHz	-20.0 dB	-20.0 dB

PART NUMBERS	
Description	Part No.
6-Way Passive Video Splitter Module	47690-6C2
8-Way Passive Video Splitter Module	47690-8C2
6-Way Passive Video Splitter	47690-0G6
8-Way Passive Video Splitter	47690-0G8

For further support information, visit [Leviton.com/ns/support](https://leviton.com/ns/support)