

## Recessed Entertainment Box (REB)

### APPLICATION

The Leviton Recessed Entertainment Box (REB) is designed to help the installer manage home theater electronics from a single location. The REB centralizes device connection points for all AC power, audio, video, home theater, data, and phone connections. The REB enables consumers to take advantage of technologies such as satellite TV, internet access, home networking, whole-house audio/video and more.

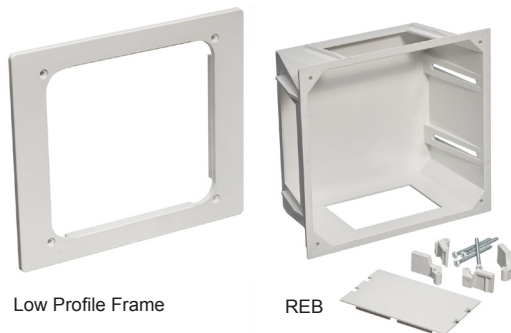

Low Profile Frame

REB



High Profile Frame

### SPECIFICATION

The Recessed Entertainment Box (REB) shall be a recessed mounting solution for up to three low-voltage or line-voltage devices. The REB shall be molded from paintable white, fire-retardant ABS and include three openings for single-gang old-work wing-clip style device boxes and low-voltage brackets. The REB shall be suitable for new construction mounting on studs or retrofit applications using the provided hardware. The REB shall be available in two configurations: the first configuration shall include a white Low-Profile Frame (trim ring), the second configuration shall include a clear High-Profile Cover and white frame and, the cover shall be constructed of clear polycarbonate. Both configurations shall include one snap-in plate for unused device openings, the snap-in plate shall include a knockout supporting cable pass-through. The Low-Profile Frame, High-Profile Cover, and additional snap-in plates shall be available as separate accessories.

### FEATURES

- Using user provided "old work" junction boxes and low voltage mounting brackets, the installer can configure the three device openings with any combination of line and low voltage products to support any application
- Low profile frame hides the drywall cut and ensures a clean installation
- The REB can be used for new construction (stud-mounted) and retrofit (wall-mounted) applications.
- High Profile Cover is also available for an enclosed, finished installation
- Molded from paintable white, fire-retardant ABS

### DESIGN CONSIDERATIONS

- Mountable on studs for new construction or in drywall cutout for retrofit applications
- Three openings to mount low-voltage and line-voltage components
- Mounts in standard 2x4 constructed walls with a 3.5" or greater depth

### STANDARDS COMPLIANCE

- RoHS
- Model 47617-REB is Listed c(UL)us: UL 514, CAN/CSA-C22.2

### COUNTRY OF ORIGIN

Mexico

### MECHANICAL SPECIFICATIONS

|             |  |
|-------------|--|
| Dimensions: | See page 2   |
| Materials:  | Recessed Entertainment Box and Trim Components: white, fire-retardant ABS<br>High-Profile Cover: clear polycarbonate |

### WARRANTY INFORMATION

For Leviton product warranties, go to [Leviton.com/ns/warranty](http://Leviton.com/ns/warranty)

47617-xxx

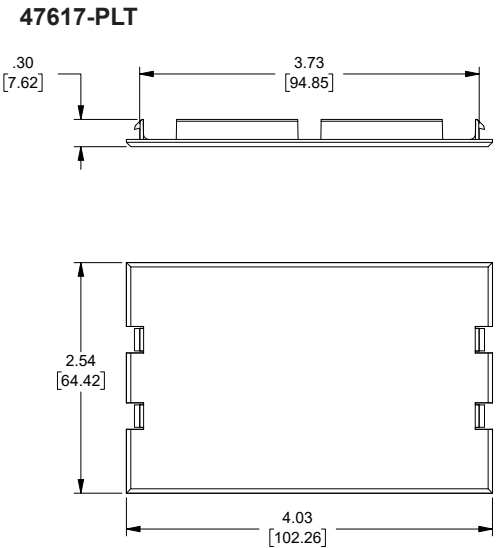
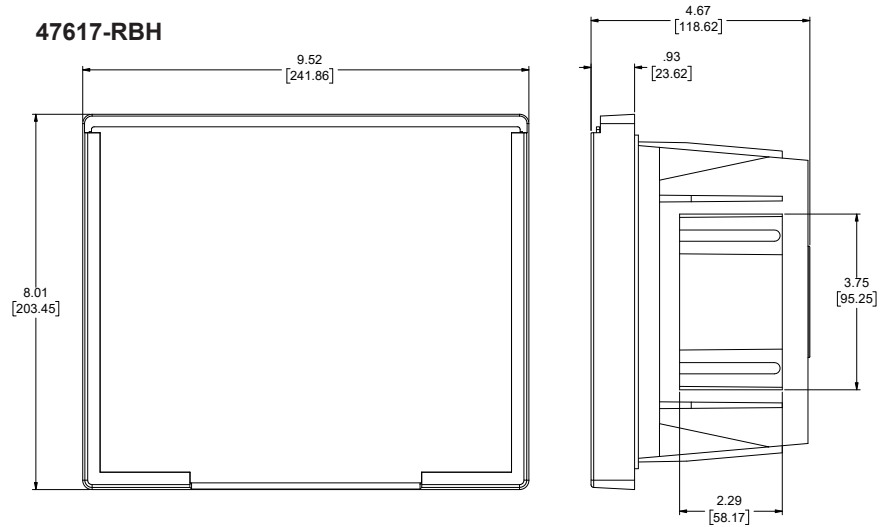
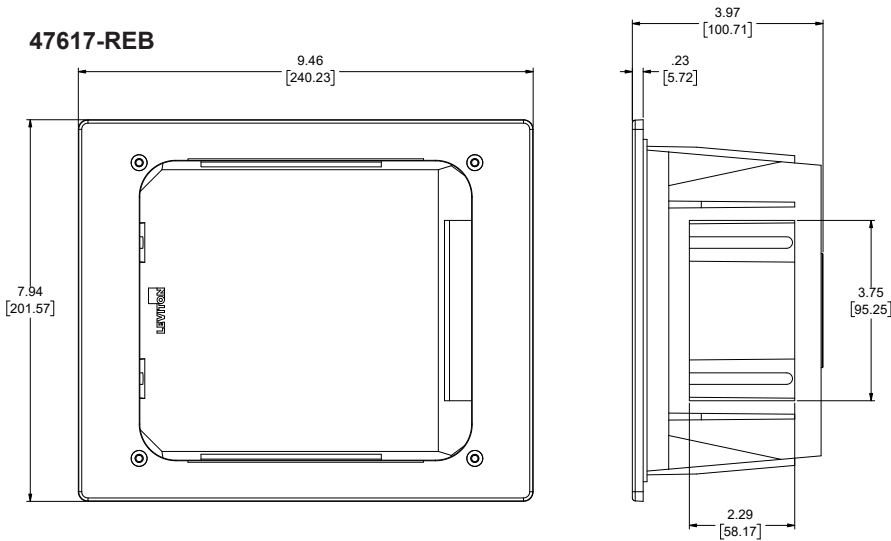

Measurements are in inches and [mm]

**PART NUMBERS**

| Description  | Part No.  |
|--|-----------|
| Recessed Entertainment Box, includes low profile frame, white            | 47617-REB |
| Recessed Entertainment Box, includes high profile frame with clear cover | 47617-RBH |
| High Profile Frame, white  | 47617-HPC |
| Low Profile Frame, white   | 47617-LPF |
| Replacement snap-in plates (2)   | 47617-PLT |

For further support information, visit [Leviton.com/ns/support](http://Leviton.com/ns/support)