

Lumina™ RF Decora® Keypad Room Controller

For Use with Lumina RF Wireless Room Control System



Description

The Lumina™ RF Decora® Keypad Room Controller (DLDNK) is the primary user interface for a Lumina RF Wireless Room Control System, combining both familiar pushbutton control and energy management business logic into line voltage-powered wireless communication devices. The Lumina RF Keypad manages a room by coordinating activities of all Lumina RF Wireless Devices within the space.

Lumina RF Wireless Room Control System

The Keypad works with compatible wireless devices to create an advanced intelligent lighting system that can be used to comply with IECC, ASHRAE 90.1, and 2019 Title 24, Part 6 occupancy/vacancy sensing, 0-10V dimming, and daylight harvesting requirements. Dimming, multi-zone daylight harvesting, occupancy and vacancy sensing, manual control, and scene control are configured using the Bluetooth®-enabled Lumina RF Wireless App.

The Keypad also provides the primary interface between the smartphone/tablet commissioning and control device and the Lumina RF Wireless Room Control System. Wirelessly configure, control, monitor and provision the Lumina RF Wireless Room Control system using the Bluetooth®-enabled Lumina RF Wireless App designed for an Android or iOS smart phone and other compatible devices within a 30' range.

Applications

- Daylight harvesting with occupancy and light level sensing with optional LURPC Photocell
- Room entry stations or remote (3-way) switch for use at other entry doors
- Coordination of Lumina RF Wireless energy management devices in a space
- Control of Intellect-enabled lamps and fixtures. Contact factory for more information.

Features

- Bluetooth interface for connection to any Android or iOS devices with Bluetooth 4.0 with BLE—download the Lumina RF Wireless App at Google Play or the Apple App Store
 - Configuration
 - Control
 - Status monitoring
- Every node is a repeater
- Line voltage powered
- Implements energy management business logic for Lumina RF Wireless devices
- Customizable buttons that can be programmed through the Leviton Lumina RF Wireless App to perform a variety of functions:
 - Room ON/OFF
 - Group ON/OFF
 - Scene
 - Any fixture at any level
 - Fade time
 - Preset groups
 - Toggle
- Button LEDs monitor and track actual room status
- Decora aesthetic
- Available in 1-, 2-, 4- and 8-button models
- LED status indicators
- Multiple operating modes: toggle maintained, toggle momentary and preset
- Can be used to comply with IECC, ASHRAE 90.1, and 2019 Title 24, Part 6 occupancy/vacancy sensing, 0-10V dimming and daylight harvesting requirements

Leviton Manufacturing Co., Inc. Lighting & Controls

20497 SW Teton Avenue, Tualatin, OR 97062 tel 800-736-6682 tech line (6:00AM-4:00PM PT Mon-Fri) 800-959-6004

©2021 Leviton Manufacturing Co., Inc. All rights reserved. Subject to change without notice.

Product Data

DLDNK-xxx

Dimensions Diagram

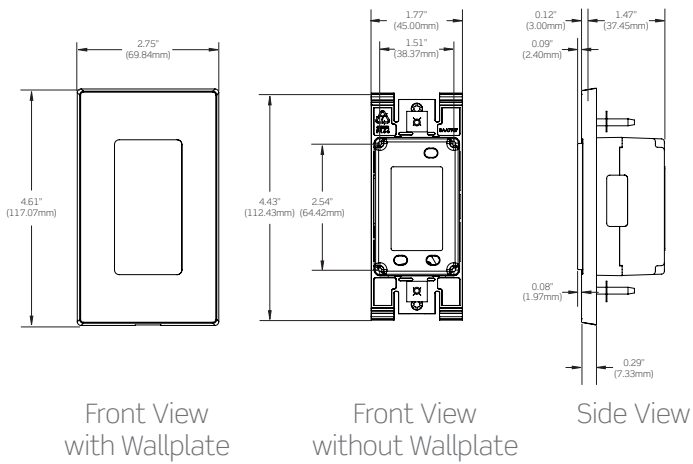

Wiring Diagram

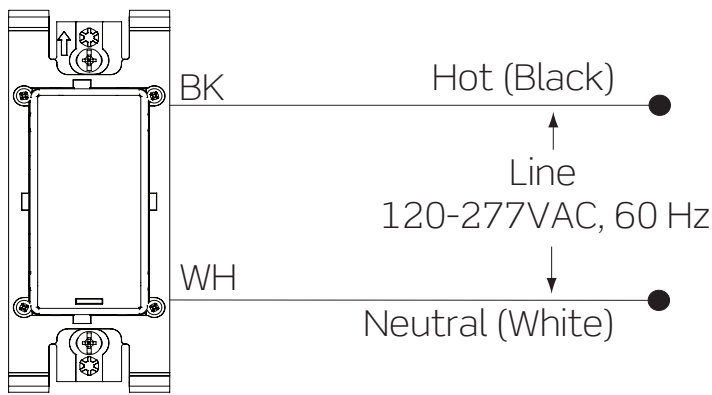

Wireless Communication

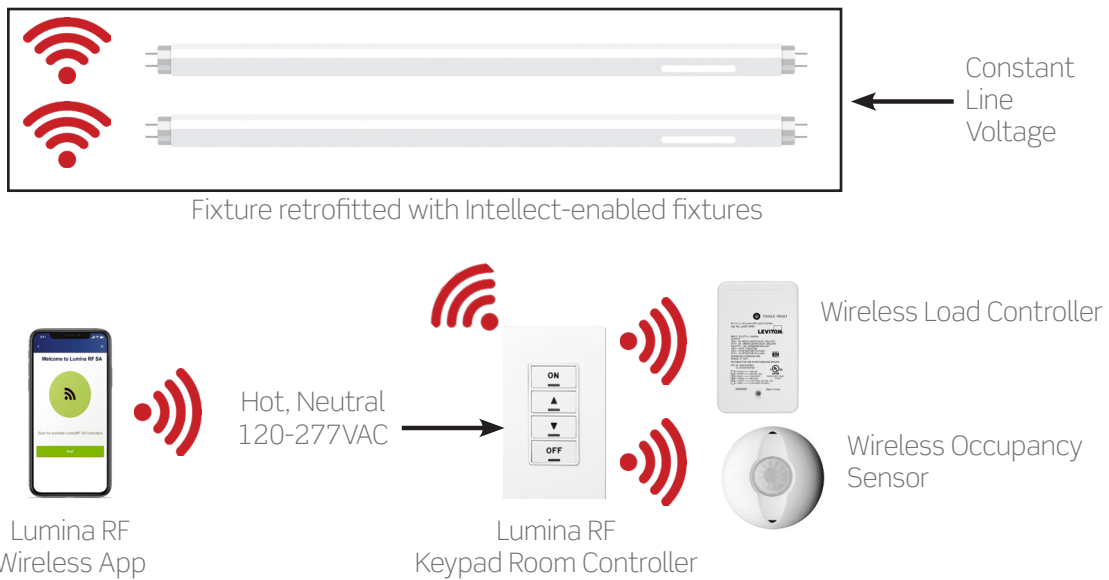

Lumina RF Wireless Compatibility Chart

Lumina RF Wireless Room Control System*		
Room Controllers*		DL05S-D0Z Lumina RF Decora® Wall Switch Room Controller with 5A Relay
		DL057-D0Z DL057-30Z Lumina RF Decora® 0-10V Dimming Room Controller with 5A Relay
		DL057-30Z DL057-30Z Lumina RF Decora® 0-10V Dimming Room Controller with 5A Relay
Compatible Products**		
Load Control Devices		LU20S-DNW Wireless 20A ON/OFF Switching Power Pack
		LU107-DNW Wireless 10A 0-10V Dimming Power Pack
		LU04P-1NW Wireless 800W Phase Cut Dimming Power Pack
ON/OFF Switch		ZS10S-D0Z Wireless ON/OFF Decora® Wall Switch
0-10V Dimmer		ZS057-D0Z ZS057-30Z ZS057-ALZ Wireless 0-10V Decora® Wall Dimmer
1000W Dimmer		DL1KD-1BZ Lumina RF 1000W Full Phase Dimmer
Receptacle		ZSTLR-1HW Wireless Controlled Receptacle
Occupancy Sensors		ZSC04-INW ZSC15-INW Wireless PIR Occupancy Sensors
Photocells		LURPC-01W Wireless Photocell
Configurator Tool		Lumina RF Standalone App Download via Google Play or Apple App Store

*Room Controllers can also be used as Remote Keypads for multi-way switching

**Not compatible with other Lumina RF Gateway products. Contact Leviton for more information.

Specifications

Electrical	
Input Voltage	120-230-277VAC , 50/60 Hz, 40mA
Output	None—wireless communication only
Radio Frequency	2.4 GHz wireless mesh network
IP Rating	IP30
Network Connections	IEEE 802.15.4, Up to 75' between Lumina RF devices, mesh network—all devices are repeaters, up to 30' between Keypad and Bluetooth phone or tablet, 75' between Keypad and first fixtures
Connections	16 AWG (Power connections)
Environmental	
Operating Temperature Range	32° F to 122° F (0° to 50° C)
Storage Temperature Range	-4° to 185° F (-20° to 85° C)
Relative Humidity	0 to 90% non-condensing, for indoor use only
Other	
Energy Codes	Can be used to comply with IECC, ASHRAE 90.1, and 2019 Title 24, Part 6 occupancy/vacancy sensing, 0-10V dimming, and daylight harvesting requirements
Listings	UL/cUL Certified, UL924, NOM Listed, RoHS 2 Compliant, and IEC61000-4-2, UL916 standard for energy management equipment
Radio Certifications	FCC certified for wireless communication (U.S.), FCC ID: QGH-DLDNK, IC Certified (Canada), IC ID: 2473A-DLDNK
Warranty	5-Year Limited

Ordering Information

Product Name	
Cat. No.	Description
DLDNK-01W	Lumina RF Decora 1-Button multi-function BLE keypad with room controller and LED feedback functionality, 120-277VAC, 50/60Hz, White
DLDNK-02W	Lumina RF Decora 2-Button multi-function BLE keypad with room controller and LED feedback functionality, 120-277VAC, 50/60Hz, White
DLDNK-04W	Lumina RF Decora 4-Button multi-function BLE keypad with room controller and LED feedback functionality, 120-277VAC, 50/60Hz, White
DLDNK-05W	Lumina RF Decora 8-Button multi-function BLE keypad with room controller and LED feedback functionality, 120-277VAC, 50/60Hz, White

Leviton Manufacturing Co., Inc. Lighting & Controls

20497 SW Teton Avenue, Tualatin, OR 97062 **tel** 800-736-6682 **tech line** (6:00AM-4:00PM PT Mon-Fri) 800-959-6004

Leviton Manufacturing Co., Inc. Global Headquarters

201 North Service Road, Melville, NY 11747-3138 **tel** 800-323-8920 **tech line** (8:30AM-7:00PM ET Mon-Fri) 800-824-3005

Visit our Website at: www.leviton.com/luminarf

©2021 Leviton Manufacturing Co., Inc. All rights reserved. Subject to change without notice.

G-10081J/B21-aa
REV FEB 2021