

# LumaCAN Repeater



## DESCRIPTION

Leviton's 2- and 6-port repeaters are designed to repeat LumCAN/CAN data out each port to extend the network length and increase device density, or creating a home-run network topology.

**2-port typical application:** extend run length

**6-port typical application:** extend run length and home-run topology

## DIMENSIONS - 2-PORT

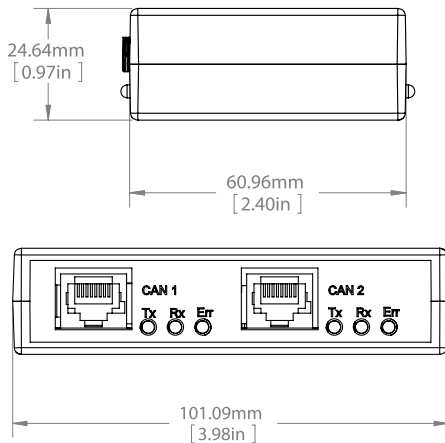

## DIMENSIONS - 6-PORT

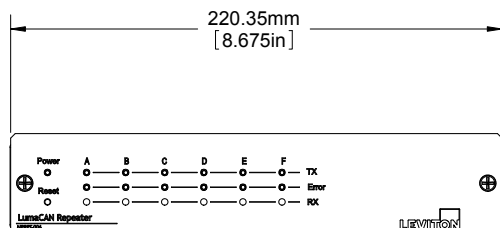

## FEATURES

- Expands LumaCAN network configuration options to include star and home run topology
- Extends LumaCAN total network length up to 10,000 ft (3,048m) made up of maximum 1,600 ft (480m) segments
- Six port repeater has “Through” port for port #1
- Max width = 7 repeaters
- Max depth = 3 repeaters
- LED Indicators: RX/Link, TX/Link, Error
- Reset switch
- Update software via USB
- Rack ears included with 6 port repeater for mounting in a standard EIA 19” rack, 1 RU or can be desktop mounted
- 2 port repeater installation is up to the discretion of contractor as required by field conditions; device may be installed into a field box or surface mounted
- Two 6-port repeaters may be installed side-by-side in side-by-side 1RU space

## POWER NOTE

**Power Supply**—requires +12-24VDC, 0.5A. Power supply not included. May be powered from LumaCAN network or dedicated supply

**Power Routing**—each power can “bridge” power to the adjacent port or segment based on network requirements. Reference document “LumaCAN Power Considerations White Paper” on [www.leviton.com](http://www.leviton.com) for additional details

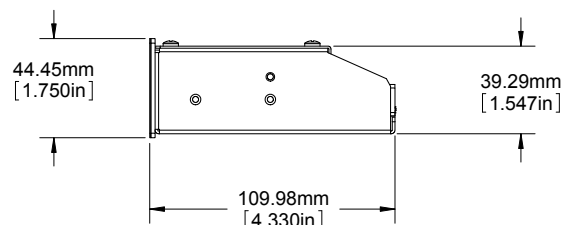

Leviton Mfg. Co., Inc. Lighting & Energy Solutions

20497 SW Teton Avenue, Tualatin, OR 97062 1-800-736-6682 Tech Line: 1-800-959-6004 Fax: 503-404-5594 [www.leviton.com/les](http://www.leviton.com/les)  
 © 2012 Leviton Manufacturing Co., Inc. All rights reserved. Subject to change without notice.

WIRING DIAGRAMS

2-PORT REPEATER USED AS NETWORK EXTENDER

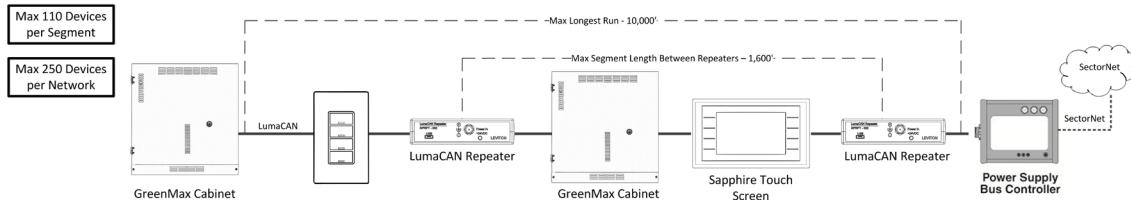

6-PORT REPEATER USED WITH HOME-RUN TOPOGRAPHY

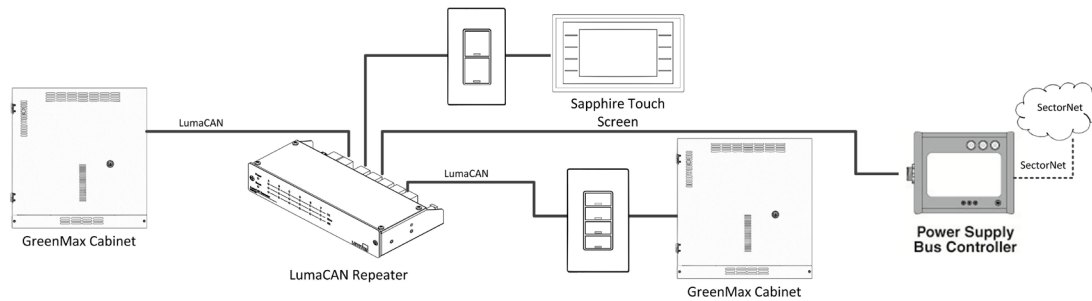

6-PORT REPEATER USED WITH HOME-RUN TOPOGRAPHY

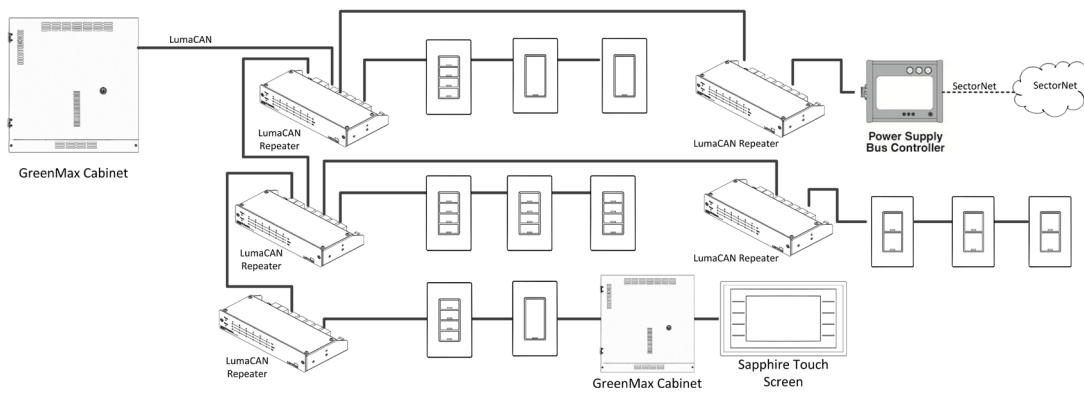

LumaCAN Repeater

SPECIFICATIONS

Power Requirements	+12-24 VDC, can be powered via a LumaCAN bus	
Power Consumption	<b>2-Port</b>	<b>6-Port</b>
	40-80mA	85-170mA
Dimensions	<b>2-Port</b>	<b>6-Port</b>
	3.98" (10.11cm) x 2.4" (6.10cm) x 0.97" (2.46cm)	8.68" (22.04cm) x 4.33" (10.998cm) x 1.55" (3.93cm)
Weight	<b>2-Port</b>	<b>6-Port</b>
	0.1 lbs (0.05kg)	1.6 lbs (0.73kg)
Operating Temperature Range	32°F to 122°F (0°C to 50°C)	
Relative Humidity	5% to 95% non-condensing, for indoor use only	

ORDERING INFORMATION

CAT. NO.	DESCRIPTION
NPRPT-002	LumaCAN 2-Port Pocket Repeater
NPRPT-006	LumaCAN 6-Port Repeater
ACCESSORIES	
EIA00-S01	1RU 19" EIA Rack, surface mount enclosures, opening in side. Removable front cover.

Leviton Mfg. Co., Inc. Lighting & Energy Solutions

20497 SW Teton Avenue, Tualatin, OR 97062 1-800-736-6682 Tech Line: 1-800-959-6004 Fax: 503-404-5594 www.leviton.com/les  
 © 2012 Leviton Manufacturing Co., Inc. All rights reserved. Subject to change without notice.