

LumaCAN Power Inserter

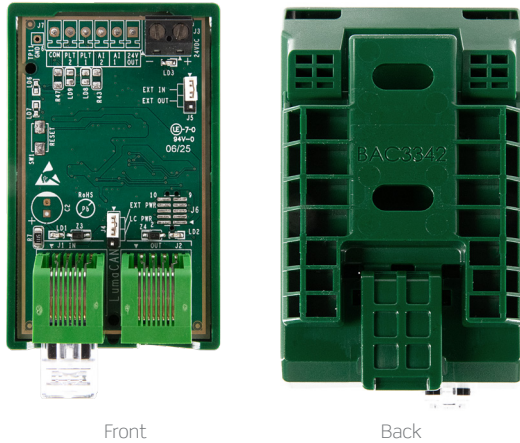

Description

The LumaCAN Power Inserter is a DIN rail-mounted adapter designed for versatile power distribution. It includes dual RJ45 ports that can either link power between them or isolate power to prevent sharing. To ensure stable and efficient operation, each network segment should be powered by a single supply, regardless of configuration.

When introducing power into the LumaCAN network, a Class 2 power supply is required. Each power segment supports up to 1.5A and to prevent excessive current, the power inserter features integrated overcurrent protection.

Features

- Inject power into a LumaCAN network from an external 24V class 2 power supply
- Provide LumaCAN 24VDC to a local sensor or device
- Power isolation between two network segments (external power supply is not required for this application)
- Connects via the LumaCAN network via RJ45 connectors and CAT6 wiring. Pass-through connectors are prohibited. The use of pass-through RJ45 connectors is unneeded.
- Current limited to 1.5A on the output terminal
- LED indicators for both input power supply and output power
- Diode protected to prevent power supply back feed
- Includes surface mount plate

Dimensions - Core

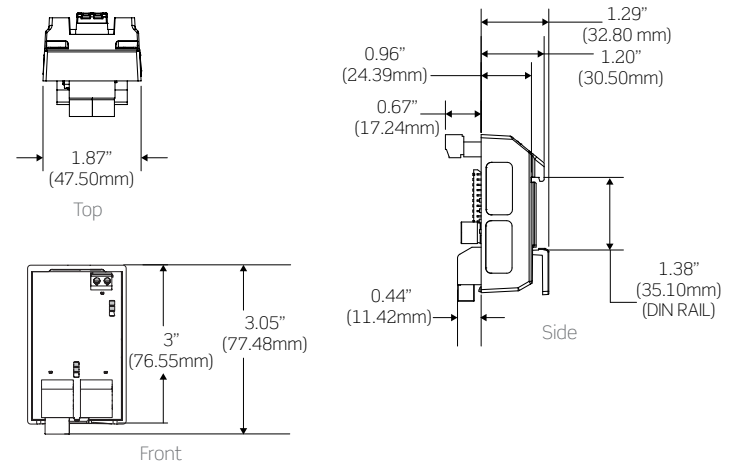

Dimensions - Mounting Plate

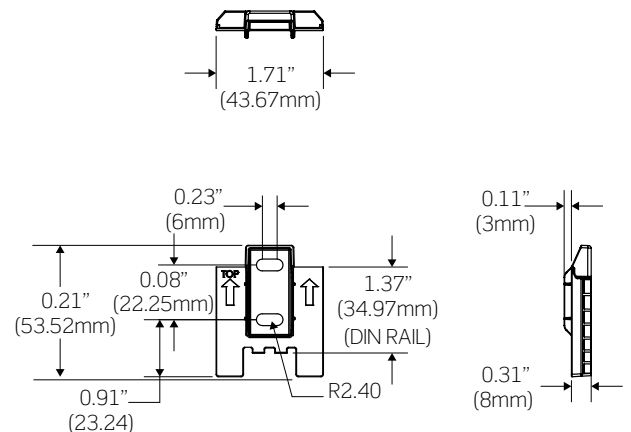

Wiring Diagrams

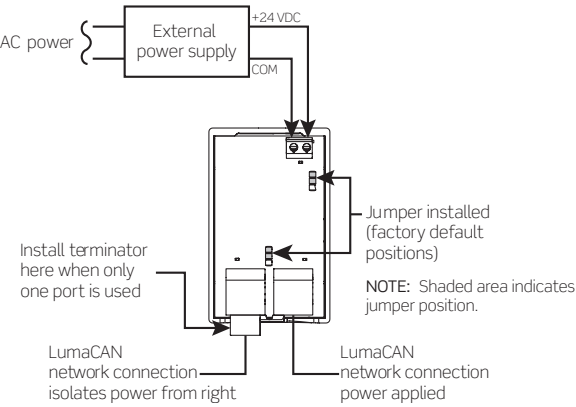

Typical Power Inserter Configuration

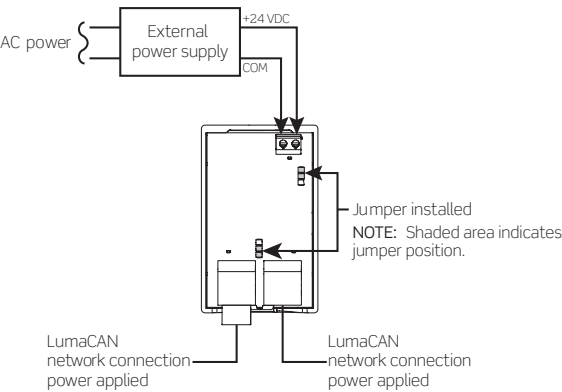

Alternate Power Inserter Configuration

Specifications

Electrical	
Input Voltage	+24VDC
Input Current	Varies based on configuration, the DRAD0-PIN consumes no power
LumaCAN Output Power	No greater than available input current, however, output is current limited to 1500mA
Terminal Torque Rating, Low Voltage	5 lb-in
Network Connections	<ul style="list-style-type: none">• LumaCAN via (2) RJ45 connections• Termination provided via termination plug• Note: The use of pass-through RJ45 connectors is prohibited. Their use will void the system warranty.
Environmental	
IP Rating	10
Operating Temperature	32° to 104°F (0° to 85°C)
Storage Temperature	14° to 185°F (-10° to 85°C)

Ordering Information

LumaCAN Power Inserter	
Cat. No.	Description
DRAD0-PIN	LumaCAN Power Inserter. Used to inject power onto LumaCAN network from any 24VDC power supply. DIN Rail Mount or surface mount with included bracket.
DRID0-EAR	Spare bracket provided for surface mounting when original branded bracket is unavailable

Leviton Manufacturing Co., Inc. Lighting & Controls

10385 SW Avery Street, Tualatin, OR 97062 **tel** 800-736-6682 **tech line** (6:00AM-4:00PM PT Mon-Fri) 800-959-6004

Leviton Manufacturing Co., Inc. Global Headquarters

201 North Service Road, Melville, NY 11747-3138 **tel** 800-323-8920 **tech line** (8:00AM-10:00PM ET Mon-Fri, 9:00AM-7:00PM ET Sat, 9:00AM-5:00PM ET Sun) 800-824-3005

Visit our Website at: www.leviton.com/greenmaxdrc

©2025 Leviton Manufacturing Co., Inc. All rights reserved. Subject to change without notice.

LES-G-10807/H25-aa