

GreenConnect Wireless 1000W Forward Phase Wall Dimmer



Description

GreenConnect delivers simple wireless lighting control by adding wireless control to virtually any switching or dimming load. Compatible with various lamp fixtures and load control devices, GreenConnect offers a scalable and flexible wireless solution to meet the control needs of virtually any space. No new wiring, room controller, hub or commissioning required. Ideal for retrofits and new construction.

The GreenConnect Wireless 1000W Forward Phase Wall Dimmer (ZBM00) is a robust Decora® dimmer switch. Use it to control a local lighting load, including high inrush LED, or pair it with another ZB700 in a GreenConnect network for multi-way switching or dimming.

Features

- Use as a standalone dimmer switch, or pair with another switch, dimmer, or sensor in a GreenConnect network of up to 16 devices
- Compatible with multiple load types
- Robust and reliable mechanically-held latching High Inrush Stability (HIS) relay for large commercial loads
- Classic Decora® rocker with dimming bar for simple ON/OFF and raise/lower control
- LED indicators for light level and locating in a dark room
- Easy installation in any single-gang device box
- Includes White, Ivory and Light Almond face plates
- Color change kits available in White, Ivory, Light Almond, Gray, Black, and Brown
- Complies with IEEE 802.15.4 standards for domestic and international wireless networks
- Can be used as a component in a system to meet code requirements for IECC, ASHRAE 90.1, and 2022 Title 24, Part 6 space/area control, dimming, manual-ON/OFF, occupancy/vacancy control and automatic shutoff requirements

Wiring Diagrams

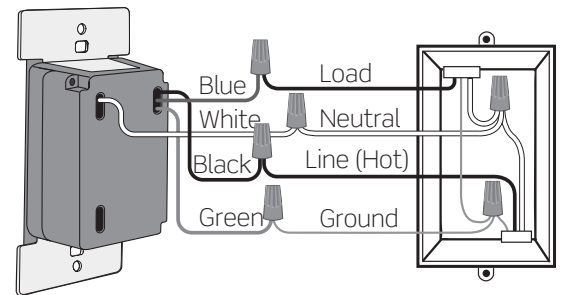
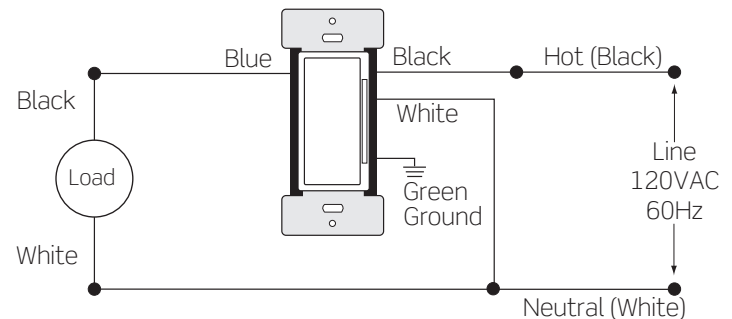

User Interface

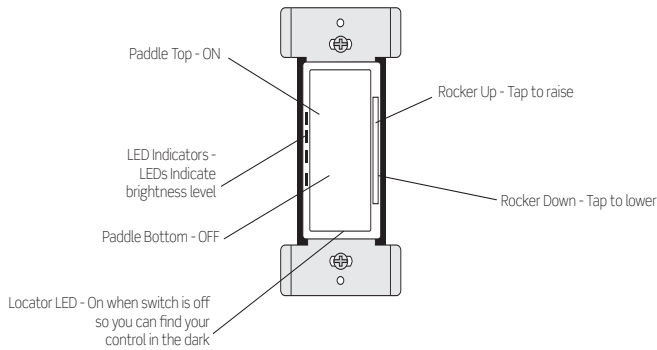

Dimensions

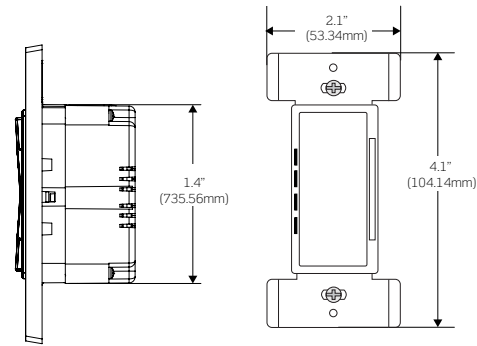

Specifications

Electrical

Input Voltage/Frequency	120VAC, 60Hz		
Input Current	Standby: 0.2W, Max: 0.5W+Load Power		
Load Ratings	Single	Two Devices	More than Two Devices
LED, CFL, Electronic Ballast @ 120V	1000W	680W	600W
Magnetic Ballast @ 120V			
Resistive, Tungsten @ 120V	Not rated for use		
Motor @ 120V	Not rated for use		
UL Impulse Voltage	2500V <120V>		
UL Pollution Degree	2		
UL Disconnection Type	Micro		

Environmental

Operating Temperature	32°F to 104°F (0°C to 40°C)
Storage Temperature	-40°F to 185°F (-40°C to 85°C)

Other

Energy Codes	Can be used as a component in a system to meet code requirements for IECC, ASHRAE 90.1, and 2022 Title 24, Part 6 space/area control, dimming, manual-ON/OFF, occupancy/vacancy control and automatic shutoff requirements
IP Rating	IP10
Network Connection	IEEE 802.15.4, 2.4Ghz wireless mesh network up to 75' range between devices
Weight	0.25lbs (0.11kg)
Warranty	5-Year

Ordering Information

GreenConnect Wireless 1000W Forward Phase Dimmer

Cat. No.	Description
ZBM00-10W	GreenConnect 1000W Forward Phase Dimmer; 120VAC, 60Hz; Neutral Required; Color: White, Light Almond, Ivory
DDKIT-0Sx*	Color Change Kit

*Color change kits available in the following colors: White (-W), Ivory (-I), Light Almond (-T), Gray (-G), Black (-E), and Brown (-B). To order, replace x with the color suffix.

Leviton Manufacturing Co., Inc. Lighting & Controls

10385 SW Avery Street, Tualatin, OR 97062 **tel** 800-736-6682 **tech line** (6:00AM-4:00PM PT Mon-Fri) 800-959-6004

Visit our Website at: www.leviton.com/greenconnect

©2024 Leviton Manufacturing Co., Inc. All rights reserved. Subject to change without notice.

LES-G-10796/L24-aa