

Omni-Bus™ Low Voltage 3x3 Wall Stations

IEC Form Factor



DESCRIPTION

The Omni-Bus™ Low Voltage 3x3 Wall Stations are IEC form factor stations designed for modular load control of the Omni-Bus network. The Omni-Bus Low Voltage Wall Stations can be configured to operate any Omni-Bus load or scene. The programmable stations offer versatility for central lighting control. Omni-Bus utilizes a DIN rail mount modular system for controlling CFL, LED, electronic low voltage, halogen and incandescent lighting. Omni-Bus devices can be installed anywhere to save wiring and installation costs.

FEATURES

- Models include 1-, 2-, 4-, and 6-button configurations for control of Omni-Bus devices
- Standalone or PC-based programming
- Multiple LED display options including intensity control
- Red/green LED status for load or scene
- RJ45 connectors for connection to Omni-Bus networks
- Requires 1-gang IEC backbox
- Custom engraving available



SYSTEM FEATURES

- Modular DIN rail mount load control system
- Offers a variety of load control options
- LED Ready
- Channel based on scene control
- Occupancy sensor integration
- Connectivity to Omni Controller

OMNI-BUS QUICK STATS

- Daisy chain topology or home run with use of a hub
- CAT6 wiring or better
- Power and data provided on CAT6 cable
- RJ45 connectors
- Maximum data run length: 1,000 meters
- Maximum number of devices:
 - Physical devices (complete modules/keypads) 256 max/system
 - Logical devices (each channel/switch) 512 max/system
- Maximum current per segment: 1.5A

APPLICATIONS

- Retail
- Classrooms
- Conference rooms
- Office spaces
- Ballrooms
- Auditoriums
- Multi-purpose rooms
- Low voltage distribution applications
- Any location requiring standalone or networked lighting control solutions

PRODUCT DATA

DIMENSIONS

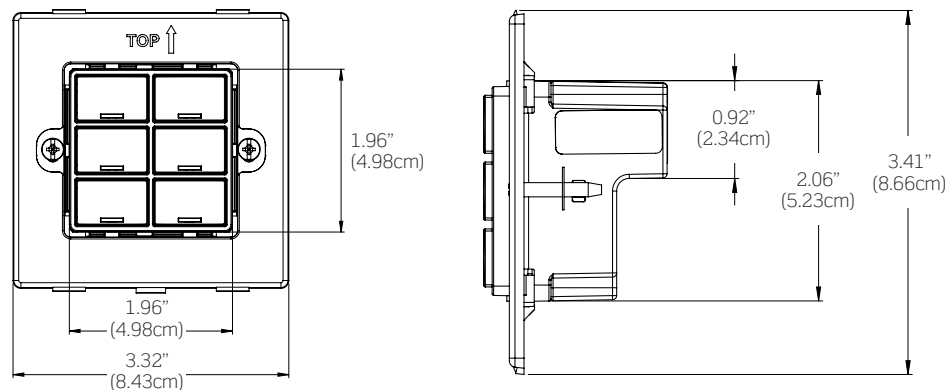

WIRING DIAGRAM

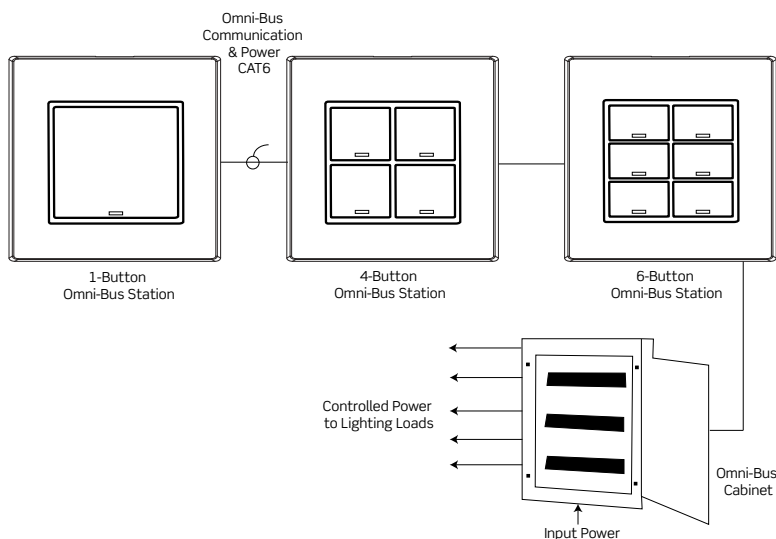

SPECIFICATIONS

ELECTRICAL	
Input Power	+15-24VDC (via Omni-Bus network cable)
Consumption	30mA
Connectors	RJ45
ENVIRONMENTAL	
Ambient Temperature	32 to 104°F (0 to 40°C)
OTHER	
Listings	FCC, CSL/CE/IEC 60730-1
Ingress Protection	IP20
Warranty	Limited 2-year warranty

ORDERING INFORMATION

CAT. NO.	DESCRIPTION
OBKBD-x0W*	Omni-Bus Low Voltage 3x3 Wall Station
WPDB0-10x**	1-Gang Decora Screwless Wallplate

*Replace "x" to indicate number of buttons: 1, 2, 4, or 6

**Replace "x" to indicate color: (W)White, (I)Ivory, (T)Light Almond, (E)Black. Note that wallplates are sold separately.

NOTE: Contact factory for custom engraving information

WALL STATION COLOR CHANGE KIT ORDERING KEY

CKDBK -	<input type="checkbox"/>	<input type="checkbox"/>	<input type="checkbox"/>
BUTTONS	OPTIONS	COLOR	
1	0 = Color	W = White	
2	Change Kit	I = Ivory	
4	E = Engraved	T = Light Almond	
6		G = Gray	
		E = Black	
		R = Red	

Leviton Manufacturing Co., Inc. Global Headquarters

201 North Service Road, Melville, NY 11747-3138 tel 800-323-8920 fax 800-832-9538 tech line (8:30AM-7:00PM ET Mon-Fri) 800-824-3005

Leviton Manufacturing Co., Inc. Energy Management, Controls and Automation

4330 Michoud Blvd., New Orleans, LA 70129 tel 504-736-9810 fax 504-253-2954

Visit our Website at: www.leviton.com/omnibus

©2017 Leviton Manufacturing Co., Inc. All rights reserved. Subject to change without notice.

G-10105/F17-tb