



DECORA
COLLECTION BY LEVITON

MONET

Single Pole (One location) or
3-Way (Multi-location)
plus Scene Capabilities

120VAC, 60Hz

Cat. No. MNE04-1L, 400VA
(Lighted, Narrow Fin)

Total minimum load must exceed 60VA

For use w/ Cat. No. MN00R-D Monet™ Remote

INSTALLATION INSTRUCTIONS



DI-000-MNE04-00A

LIMITED 2 YEAR WARRANTY AND EXCLUSIONS

Leviton warrants to the original consumer purchaser and not for the benefit of anyone else that this product at the time of its sale by Leviton is free of defects in materials and workmanship under normal and proper use for two years from the purchase date. Leviton's only obligation is to correct such defects by repair or replacement, at its option, if within such two year period the product is returned prepaid, with proof of purchase date, and a description of the problem to Leviton Manufacturing Co., Inc., Att: Quality Assurance Department, 59-25 Little Neck Parkway, Little Neck, New York 11362-2591 (In Canada send to Leviton Mfg. of Canada Ltd., 165 Hymus Blvd., Point Claire, (Quebec), Canada H9R 1E9). This warranty excludes and there is disclaimed liability for labor for removal of this product or reinstallation. This warranty is void if this product is installed improperly or in an improper environment, overloaded, misused, opened, abused, or altered in any manner, or is not used under normal operating conditions or not in accordance with any labels or instructions. There are no other or implied warranties of any kind, including merchantability and fitness for a particular purpose, but if any implied warranty is required by the applicable jurisdiction, the duration of any such implied warranty, including merchantability and fitness for a particular purpose, is limited to two years. Leviton is not liable for incidental, indirect, special, or consequential damages, including without limitation, damage to, or loss of use of, any equipment, lost sales or profits or delay or failure to perform this warranty obligation. The remedies provided herein are the exclusive remedies under this warranty, whether based on contract, tort or otherwise.

For Technical Assistance Call:
1-800-824-3005 (U.S.A. Only)
1 800 405-5320 (Canada Only)
www.leviton.com



DI-000-MNE04-00A

FEATURES

- Leviton's Decora® style design
- Gangable with any Leviton Decora® style strap-mounted devices
- Scene Capabilities
- ON/OFF LED indicates status of load
- Square Law Dimming
- Hidden air-gap switch

INTRODUCTION

The Monet™ Dimmer is the premier model in Leviton's line of Architectural Specification Multi-Location Dimmers. The Monet™ is ideal for any application where a subtle design plays a critical role, such as in museums, galleries, and elegant dining rooms. The low-profile architectural fin design provides Monet™ with a flush-to-wall fit. The slider and cover plate feature smooth angles that won't create distracting shadows, with a matte finish to ensure minimum light reflection. Monet™ also features a soft green locator light that illuminates when the dimmer is OFF.

Monet's™ digital circuitry provides single-pole dimming and multi-location three-way switching plus scene lighting control capability for up to 6 programmable lighting scenes. Monet™ also provides gentle Fade-to-ON, Fade-to-OFF switching for eye-pleasing comfort and extended bulb life.

FCC COMPLIANCE STATEMENT

This device complies with part 15 of the FCC Rules. Operation is subject to the following two conditions: (1) This device may not cause harmful interference, and (2) this device must accept any interference received, including interference that may cause undesired operation.

INSTALLATION INSTRUCTIONS

WARNING: TO BE INSTALLED AND/OR USED IN ACCORDANCE WITH APPROPRIATE ELECTRICAL CODES AND REGULATIONS.

WARNING: IF YOU ARE NOT SURE ABOUT ANY PART OF THESE INSTRUCTIONS, CONSULT A QUALIFIED ELECTRICIAN.

WARNING: TO AVOID OVERHEATING AND POSSIBLE DAMAGE TO THIS DEVICE AND OTHER EQUIPMENT, DO NOT INSTALL TO CONTROL A RECEPTACLE, FLUORESCENT LIGHTING, A MOTOR- OR A TRANSFORMER-OPERATED APPLIANCE OTHER THAN APPROPRIATE LOW-VOLTAGE LIGHTING.

WARNING: USE WITH ELECTRONIC LOW-VOLTAGE TRANSFORMERS ONLY. **DO NOT** USE TO CONTROL A MAGNETIC LOW-VOLTAGE TRANSFORMER. USE A LEVITON MAGNETIC LOW-VOLTAGE DIMMER TO CONTROL MAGNETIC LOW-VOLTAGE TRANSFORMERS.

WARNING: THIS DIMMER PROVIDES PROTECTION FROM OVERHEATING. IF MORE THAN THE RATED WATTAGE IS APPLIED, THE LOAD WILL SHUT OFF UNTIL THE DIMMER COOLS DOWN AND RESETS. IF THIS SHOULD OCCUR, THE EXCESS LOAD MUST BE REMOVED TO RESUME PROPER OPERATION.

OTHER CAUTIONS:

1. FOR 3-WAY APPLICATIONS, USE ONLY ONE (1) DIMMER PER LOAD. FOR REMOTE OPERATION, USE CAT. NO. MN00R-D REMOTE. **DO NOT** USE A 3-WAY SWITCH.
2. BOTH LIGHTING FIXTURE AND DIMMER MUST BE **GROUND**ED.
3. DISCONNECT POWER WHEN SERVICING FIXTURE OR CHANGING LAMPS.
4. USE THIS DEVICE ONLY WITH COPPER OR COPPER CLAD WIRE. WITH ALUMINUM WIRE USE ONLY DEVICES MARKED CO/ALR OR CU/AL.

MULTI-GANG INSTALLATION (see Chart 1):

CAUTION: DO NOT GANG DIMMERS VERTICALLY (ONE DIRECTLY ABOVE ANOTHER).

- It is recommended that these dimmers be installed without breaking off fins whenever possible so that no derating is necessary, even when ganging. If the installation requires breaking off fins for space requirements, derating is required.
- When ganging a combination of narrow and wide dimmers, all narrow dimmers are required to be at one end of the gang, and all wide dimmers are required to be at the other end of the gang if ordering custom wallplates.
- Adapter plates (Cat. No. MN0LA or MN0SA) are available for multi-gang installations using any Leviton Decora® style strap-mounted device.

NOTE: The fins on the dimmers have special break off points that allow removal of partial fin sections for ganging. Use pliers to carefully bend fin side sections back and forth until they break off (see Figure 2). These sections should only be removed at the break off points to permit proper ventilation. Do not remove side sections on extreme ends of the gang.

MAXIMUM BULB WATTAGE (For Electronic Low-Voltage Only):

Low-voltage dimmers are rated in Volt-Amps (VA). The maximum bulb wattage is determined by the efficiency of the transformer in the low-voltage lighting system. Transformer efficiencies will vary from different manufacturers; consider 90% efficient as average. Use Chart 2 to determine maximum bulb wattage for typical transformer efficiency ratings.

CHART 1				CHART 2			
MAXIMUM LOAD PER CONTROL FOR MULTI-GANG WITH FINS BROKEN OFF				MAXIMUM BULB WATTAGE AT 90% EFFICIENCY			
Cat. No.	Single	Two Gang	More than 2 Gang	Rating	Single	Two Gang	More than 2 Gang
MNE04-1L	400VA	300VA	250VA	400VA	360W	315W	225W

Figure 1 – Dimmer Functions

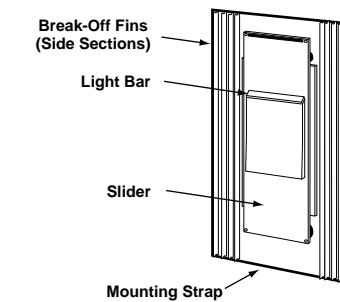
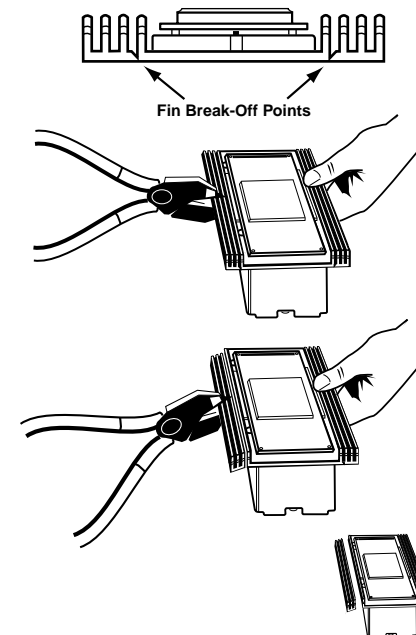
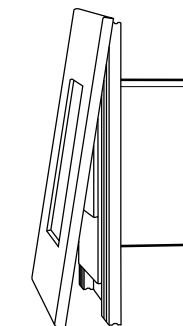

Figure 2 – Break-Off Fin Removal



**Figure 3
Wallplate Installation / Removal**





No Fins Broken Off:

Refer to **Table 1** for the size and number of outlet boxes required for multi-gang installations.

A multi-gang masonry box or a multi-gang switch box with a raised cover are *recommended* for easy installation although standard outlet boxes will work. **No derating is necessary.**

EXAMPLE: 3 Narrow Dimmers / No Wide Dimmers – 5 Gang Outlet Box (note mounting holes)

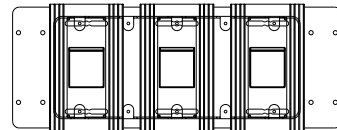

Wide Dimmers	Narrow Dimmers						
	0	1	2	3	4	5	6
0	0	1	3	5	6	9	10
1	1	4	5	7	8	10	
2	4	6	8	9			
3	7	9	10				
4	9						

Fins Broken Off:

Refer to **Table 2** for the size and number of outlet boxes required for multi-gang installations when all inside fins are removed.

EXAMPLE: 3 Narrow Dimmers / No Wide Dimmers – 3 Gang Outlet Box (note inside fins removed)

The side sections dissipate heat, so removing them requires a derating of the dimmer's capacity (see **Table 3**).

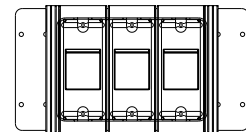

Wide Dimmers	Narrow Dimmers									
	0	1	2	3	4	5	6	7	8	9
0	0	1	2	3	4	5	6	7	8	9
1	1	3	4	5	6	7	8	9	10	
2	3	5	6	7	8	9	10			
3	5	7	8	9	10					
4	7	9	10							
5	9									

TO INSTALL:

1. WARNING: TO AVOID FIRE, SHOCK, OR DEATH; **TURN OFF POWER AT CIRCUIT BREAKER OR FUSE AND TEST THAT POWER IS OFF BEFORE WIRING!**

2. Remove existing wallplate and switch or dimmer, if applicable.

2A. Remove Monet™ wallplate from Monet™ dimmer by gently pulling at top or bottom edges until it snaps off (see **Figure 3**).

3. Remove 3/4" (1.9 cm) of insulation from each circuit conductor. Make sure the ends of wires are straight.

4. Connect lead wires per appropriate WIRING DIAGRAM as follows: **WARNING: CONNECT AN ELECTRONIC LOW-VOLTAGE DIMMER ONLY TO THE PRIMARY (HIGH-VOLTAGE) SIDE OF AN ELECTRONIC LOW-VOLTAGE TRANSFORMER.** Twist strands of each lead tightly and, with circuit conductors, push firmly into appropriate wire connector. Screw connectors on clockwise making sure that no bare conductor shows below the wire connectors. Secure each connector with electrical tape.

NOTE: For single pole applications, cap the YELLOW lead with an appropriate size wire connector. Secure connector with electrical tape.

5. Carefully position all wires to provide room in outlet box for dimmer. Mount dimmer into box with mounting screws supplied with the light bar facing up (see **Figure 1**).

NOTE: Ensure that dimmer is mounted vertically for proper heat dissipation.

6. Snap Monet™ Decora® wallplate on over heatsink (see **Figure 3**).

NOTE: Custom wallplates available for multi-gang installations.

7. Restore power at circuit breaker or fuse. **INSTALLATION IS COMPLETE.**

NOTE: When servicing a controlled fixture, position the slider to its lowest position, push slider in and down until a click is heard to activate the air-gap switch. A RED horizontal line will appear at the top of the Decora® opening to confirm that the air-gap switch is actuated and power to the fixture is cut-off. After service is completed, push slider in and up to restore power for normal operation.

TO PROGRAM

Programming scenes occurs at the scene controller for this dimmer. If programming is required, refer to scene controller's instruction sheets.

TO OPERATE

ON/OFF: Depress the slider. Each time the slider is depressed, the state of the lights will toggle between ON and OFF. When the lights turn ON, the lights will Fade-to-ON to the level of its previous state, and the GREEN light bar will turn OFF. When the lights turn OFF, the GREEN light bar will flash indicating that the slider has been depressed and the lights will Fade-to-OFF. When lights are completely OFF, the GREEN light bar will then turn ON to facilitate access to the dimmer in the dark.

DIM/BRIGHT: Move the slider up or down. The lights will brighten or dim respectively, to the level set.

Power Interruption: If a Power Interruption occurs while the lights are ON, when power is restored, the lights will brighten to the level that is set on the slider. If a Power Interruption occurs while the lights are OFF, when power is restored, the lights will stay OFF.

TROUBLESHOOTING

- Light does not turn ON and ON/OFF LED does not turn ON
 - Circuit breaker or fuse has tripped.
 - Lamp is burned out.
 - Lamp is not connected to line Neutral.
 - Switch on fixture is OFF.
 - Air-gap switch is open.
 - Overheated, correct load and allow dimmer to cool down and reset
- Dimmer does not operate
 - Dimmer BLACK wire miswired to lamp and dimmer BLUE wire miswired to LINE Hot.
- Lights flickering
 - Lamp has a bad connection.
 - Wires not secured firmly with wire connectors.

Wiring Diagram 1 – Single Location Control Application

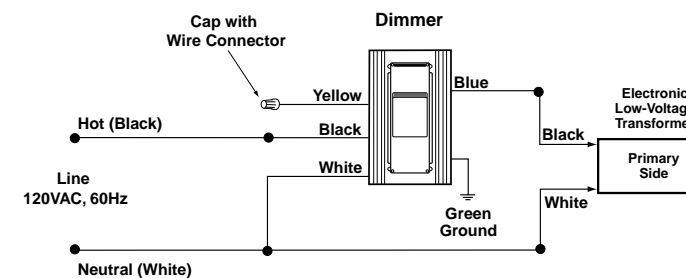

Wiring Diagram 2 – Two Location Control Application

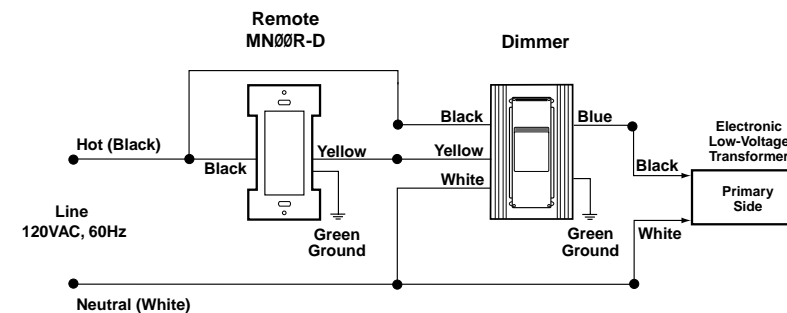

Wiring Diagram 3 – Three Location Control Application

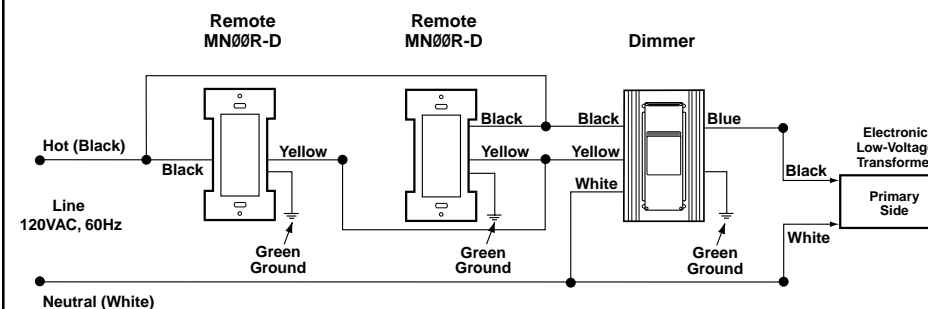

DI-000-MNE04-00A