

**WARNINGS:**

- **TO AVOID FIRE, SHOCK OR DEATH**, disconnect all power supplies to enclosure before exposing interior. More than one supply disconnect may be required to de-energize this equipment before servicing.

**CAUTIONS:**

- For installation only by an electrician in accordance with the National Electrical Code (NEC®) or the Canadian Electrical Code (CEC®) local codes.
- Separate over current protection must be provided in accordance with the NEC article 220 or CEC, Section B as appropriate.
- Use this device **WITH COPPER OR COPPER-CLAD WIRE ONLY**.
- Ensure that the rating marked on the device is correct for the intended installation.
- For Short Circuit Current Rating (SCCR) see instruction sheet that corresponds with disconnect switch model or visit Leviton.com.
- The enclosure cover cannot be removed when the handle is in the "on" position.
- Always remove the switch from the enclosure when attaching or replacing all auxiliary contacts.

PK-A3268-10-02-4B

**INSTALLATION INSTRUCTIONS**

**ENGLISH**

**100A non-fused disconnect switch**

Cat. No. 100SW

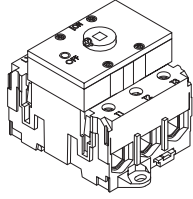

**Installation**

**WARNING: TO AVOID FIRE, SHOCK OR DEATH**, disconnect all power supplies to enclosure before exposing interior. More than one supply disconnect may be required to de-energize this equipment before servicing.

**1. Open enclosure door.**

**LDS10 - Non-Metallic boxes**  
 LDS10 - Boîtiers non métalliques  
 LDS10 - Cajas No Metálicas

**MDS10 - Metallic boxes**  
 MDS10 - Boîtiers métalliques  
 MDS10 - Cajas Metálicas

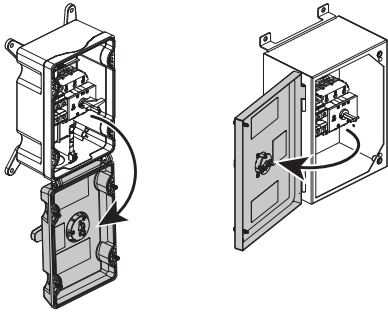

**2. Remove switch.**

**Keep screws for installing new switch.**

**Pull up tension spring.**

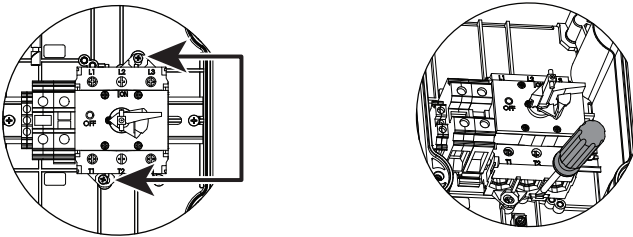

**3. Loosen set screw, then transfer shaft to new switch per measurements shown below.**

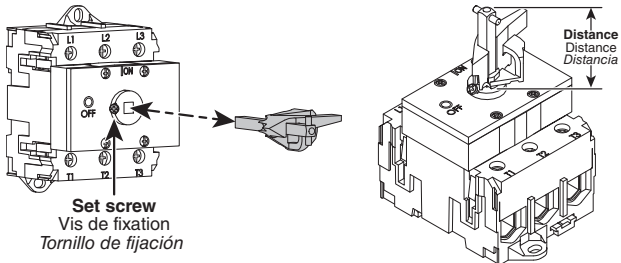

Enclosure Type	Distance
LDS10 - Non-Metallic boxes	1.085 in.
MDS10 - Metallic boxes	1.263 in.

**NOTE:** Flag only used on switched installed inside LDS-10 non-metallic boxes.

**4. Install replacement switch.**

**NOTE:** Match cross pin orientation to illustrations in step 1.

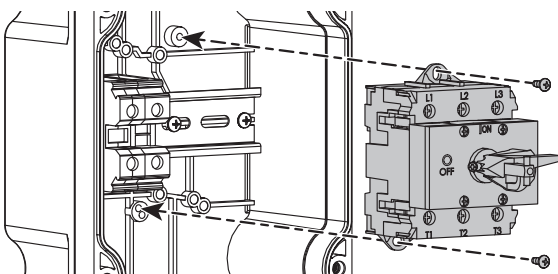

**60/80A non-fused disconnect switch**

Cat. No. 6080A

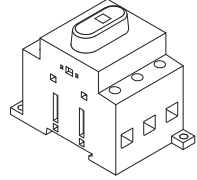

**Installation**

**WARNING: TO AVOID FIRE, SHOCK OR DEATH**, disconnect all power supplies to enclosure before exposing interior. More than one supply disconnect may be required to de-energize this equipment before servicing.

**1. Open enclosure door.**

**LDS60 - Non-Metallic boxes**  
 LDS60 - Boîtiers non métalliques  
 LDS60 - Cajas No Metálicas

**MDS6/MDS8 - Metallic boxes**  
 MDS6/MDS8 - Boîtiers métalliques  
 MDS6/MDS8 - Cajas Metálicas

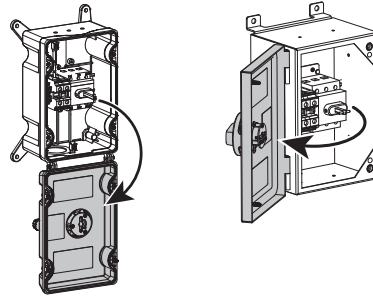

**2. Remove switch.**

**Keep screws for installing new switch.**

**Pull up tension spring.**

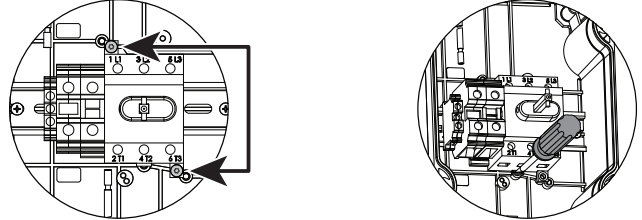

**3. Loosen set screw, then transfer shaft to new switch per measurements shown below.**

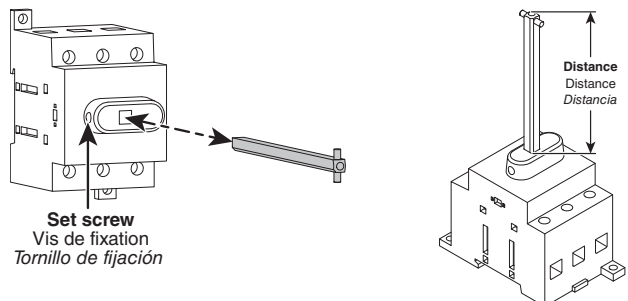

Enclosure Type	Distance
LDS60 - Non-Metallic boxes	1.989 in.
MDS6/MDS8 - Metallic boxes	1.334 in.

**4. Install replacement switch.**

**NOTE:** Match cross pin orientation to illustrations in step 1.

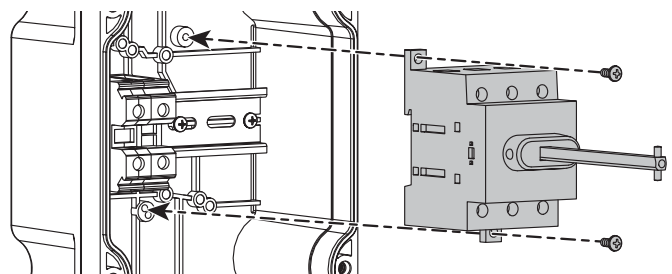

**TRADEMARK DISCLAIMER:** Use herein of third party trademarks, service marks, trade names, brand names and/or product names are for informational purposes only, are/may be the trademarks of their respective owners; such use is not meant to imply affiliation, sponsorship, or endorsement.

**FOR CANADA ONLY**

For warranty information and/or product returns, residents of Canada should contact Leviton in writing at Leviton Manufacturing of Canada ULC to the attention of the Quality Assurance Department, 165 Hymus Blvd, Pointe-Claire (Quebec), Canada H9R 1E9 or by telephone at 1-800-405-5320.

**LIMITED 3 YEAR WARRANTY AND EXCLUSIONS**

Leviton warrants to the original consumer purchaser and not for the benefit of anyone else that this product at the time of its sale by Leviton is free of defects in materials and workmanship under normal and proper use for one year from the purchase date. Leviton's only obligation is to correct such defects by repair or replacement, at its option. For details visit [www.leviton.com](http://www.leviton.com) or call 1-800-824-3005. This warranty excludes and there is disclaimed liability for labor for removal of this product or reinstallation. This warranty is void if this product is installed improperly or in an improper environment, overloaded, misused, opened, abused, or altered in any manner, or is not used under normal operating conditions or not in accordance with any labels or instructions. There are no other or implied warranties of any kind, including merchantability and fitness for a particular purpose, but if any implied warranty is required by the applicable jurisdiction, the duration of any such implied warranty, including merchantability and fitness for a particular purpose, is limited to three years. Leviton is not liable for incidental, indirect, special, or consequential damages, including without limitation, damage to, or loss of use of, any equipment, lost sales or profits or delay or failure to perform this warranty obligation. The remedies provided herein are the exclusive remedies under this warranty, whether based on contract, tort or otherwise.

