

4 3 2 1

Catalog Number	VOLTAGE	COLOR	Dimension A	Dimension B	Dimension C	Dimension D	Dimension E	Dimension F	Dimension G	Dimension H	Dimension I	CLOCK (Hr)
0W316-0R9	200-250V	BLUE	2.76" / 70 MM	3.43" / 87 MM	2.20" / 56 MM	2.76" / 70 MM	3.19" / 81 MM	2.87" / 73 MM	2.56" / 65 MM	2.13" / 54 MM	1.57" / 40 MM	
0W332-0R9			3.54" / 90 MM	4.17" / 106 MM	2.68" / 68 MM	3.31" / 84 MM	3.66" / 93 MM	3.43" / 87 MM	2.99" / 76 MM	2.40" / 61 MM	2.36" / 60 MM	
0W316-0R6	380-415V	RED	2.76" / 70 MM	3.43" / 87 MM	2.20" / 56 MM	2.76" / 70 MM	3.19" / 81 MM	2.87" / 73 MM	2.56" / 65 MM	2.13" / 54 MM	1.57" / 40 MM	
0W332-0R6			3.54" / 90 MM	4.17" / 106 MM	2.68" / 68 MM	3.31" / 84 MM	3.66" / 93 MM	3.43" / 87 MM	2.99" / 76 MM	2.40" / 61 MM	2.36" / 60 MM	
0W316-R11	440-460V	RED	2.76" / 70 MM	3.43" / 87 MM	2.20" / 56 MM	2.76" / 70 MM	3.19" / 81 MM	2.87" / 73 MM	2.56" / 65 MM	2.13" / 54 MM	1.57" / 40 MM	
0W332-R11			3.54" / 90 MM	4.17" / 106 MM	2.68" / 68 MM	3.31" / 84 MM	3.66" / 93 MM	3.43" / 87 MM	2.99" / 76 MM	2.40" / 61 MM	2.36" / 60 MM	
0W216-0R6	200-250V	BLUE	2.76" / 70 MM	3.43" / 87 MM	2.20" / 56 MM	2.76" / 70 MM	2.87" / 73 MM	2.87" / 73 MM	2.56" / 65 MM	2.05" / 52 MM	1.57" / 40 MM	
0W232-0R6			3.54" / 90 MM	4.17" / 106 MM	2.68" / 68 MM	3.31" / 84 MM	3.66" / 93 MM	3.43" / 87 MM	2.99" / 76 MM	2.40" / 61 MM	2.36" / 60 MM	
0W416-0R9	208-250V	BLUE	2.76" / 70 MM	3.43" / 87 MM	2.20" / 56 MM	2.76" / 70 MM	3.46" / 88 MM	2.87" / 73 MM	2.56" / 65 MM	2.17" / 55 MM	1.61" / 41 MM	
0W432-0R9			3.54" / 90 MM	4.17" / 106 MM	2.68" / 68 MM	3.31" / 84 MM	3.98" / 101 MM	3.43" / 87 MM	2.99" / 76 MM	2.48" / 63 MM	2.40" / 61 MM	
0W416-0R6	346-415V	RED	2.76" / 70 MM	3.43" / 87 MM	2.20" / 56 MM	2.76" / 70 MM	3.46" / 88 MM	2.87" / 73 MM	2.56" / 65 MM	2.17" / 55 MM	1.61" / 41 MM	
0W432-0R6			3.54" / 90 MM	4.17" / 106 MM	2.68" / 68 MM	3.31" / 84 MM	3.98" / 101 MM	3.43" / 87 MM	2.99" / 76 MM	2.48" / 63 MM	2.40" / 61 MM	
0W416-R11	440-460V	RED	2.76" / 70 MM	3.43" / 87 MM	2.20" / 56 MM	2.76" / 70 MM	3.46" / 88 MM	2.87" / 73 MM	2.56" / 65 MM	2.17" / 55 MM	1.61" / 41 MM	
0W432-R11			3.54" / 90 MM	4.17" / 106 MM	2.68" / 68 MM	3.31" / 84 MM	3.98" / 101 MM	3.43" / 87 MM	2.99" / 76 MM	2.48" / 63 MM	2.40" / 61 MM	
0W216-0R4	100-130V	YELLOW	2.76" / 70 MM	3.43" / 87 MM	2.20" / 56 MM	2.76" / 70 MM	2.87" / 73 MM	2.87" / 73 MM	2.56" / 65 MM	2.05" / 52 MM	1.57" / 40 MM	
0W232-0R4			3.54" / 90 MM	4.17" / 106 MM	2.68" / 68 MM	3.31" / 84 MM	3.66" / 93 MM	3.43" / 87 MM	2.99" / 76 MM	2.40" / 61 MM	2.36" / 60 MM	
0W216-0R9	380-415V	RED	2.76" / 70 MM	3.43" / 87 MM	2.20" / 56 MM	2.76" / 70 MM	2.87" / 73 MM	2.87" / 73 MM	2.56" / 65 MM	2.05" / 52 MM	1.57" / 40 MM	
0W232-0R9			3.54" / 90 MM	4.17" / 106 MM	2.68" / 68 MM	3.31" / 84 MM	3.66" / 93 MM	3.43" / 87 MM	2.99" / 76 MM	2.40" / 61 MM	2.36" / 60 MM	

D

D

C

C

B

B

A

A

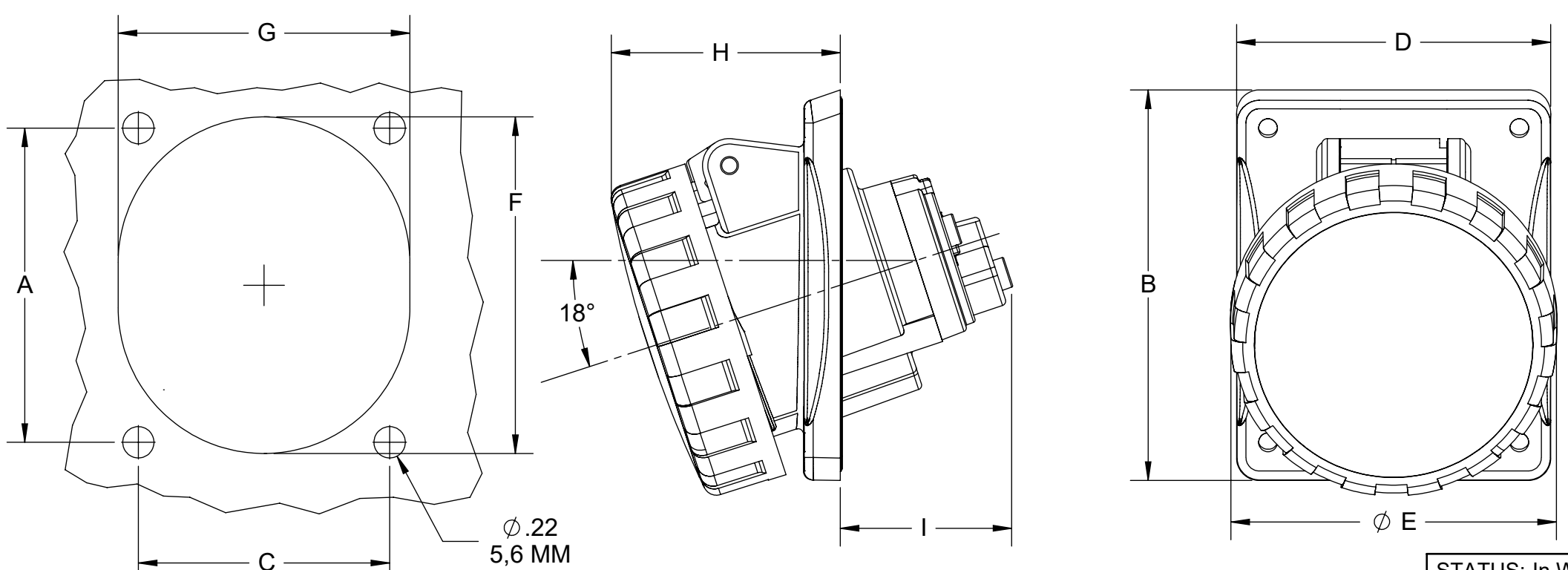

DIMENSION: INCH / MM  
REFERENCE ONLY

INTERNATIONAL PIN & SLEEVE RECEPTACLE  
IEC/EN 60309-1 & 60309-2, INTERNATIONAL  
CONFIGURATION PANEL MOUNTING SOCKET OUTLET,  
IP66/67, Watertight

STATUS: In Work					<p>The information in this document is the exclusive PROPRIETARY property of LEVITON MFG. CO., INC. It is disclosed with the understanding that acceptance or review by the recipient constitutes an undertaking by the recipient: (1) to hold this information in strict confidence. (2) not to disclose, duplicate, copy, or use the information, in whole or in part, for any purpose other than that for which disclosed. Copyright 2010. Unpublished. All Rights Reserved.</p>	<small>UNLESS OTHERWISE SPECIFIED: DO NOT SCALE DRAWING. ALL DIMENSIONS ARE IN INCHES. ALL ANGLES ARE IN DEGREES.</small>		TITLE: FLUSH MTG RECEPTACLE 16A/32A CATALOG ASSEMBLY			
REV.	DATE	ECO NUMBER	CHGD	APVD		TOLERANCES INCH .XX ± .01 .X ± .2 mm .XXX ± .005 .XX ± .1 mm		DWN BY	PR	02/15/2023	ENGRG
1	-	-	-	-	ANGLES: ± 1/2°		CHK BY	-	MFG	-	-
-	-	-	-	-	THIRD ANGLE PROJECTION		DWG NO. ORA7006-D02				
-	-	-	-	-			SIZE	PROJECT NO. PROJ-02986		REV	1
-	-	-	-	-	ALL PRINTED COPIES ARE UNCONTROLLED		C	SCALE:1:1	SHEET 1 OF 1		

4 3 2 1